

1 2 3 4 5 6 7 8

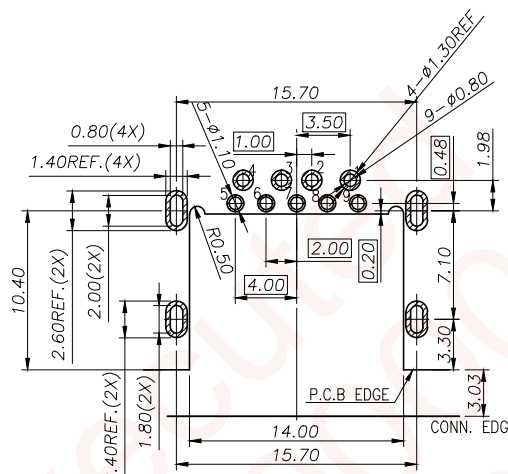
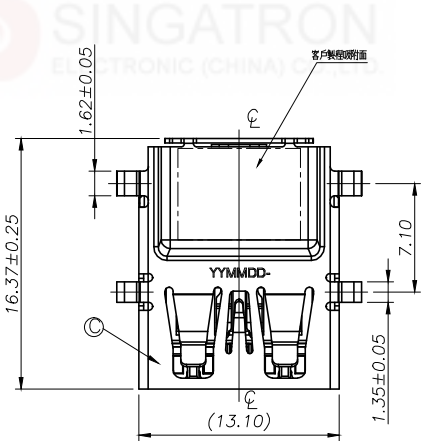

SPECIFICATIONS:

- ELECTRICAL CHARACTERISTICS:
 - CURRENT RATING: 1.8A (PIN1,4) ; OTHER CONTACTS 0.25A
 - CONTACT RESISTANCE: 30mΩ MAX INITIAL FOR PIN 1-4. 50mΩ MAX INITIAL FOR OTHER PIN.
 - DIELECTRIC WITHSTANDING VOLTAGE: 100V AC FOR 1 MINUTE
 - INSULATION RESISTANCE: 100MΩ MIN .
- MECHANICAL CHARACTERISTICS:
 - INSERTION FORCE : 2.5 KgF MAX.
 - WITHDRAWAL FORCE : 2.5KgF MAX. INITIAL : 1.0KgF. TEST AFTER : 0.80KgF.
- DURABILITY: 5,000 CYCLES.
- TO CONFORM TO SINGATRON HAZARDOUS SUBSTANCE FREE SPEC.
- HALOGEN FREE IDENTIFICATION MARK ON JACK:
- HALOGEN FREE IDENTIFICATION LABEL ON PACKAGING:
- FOR IR REFLOW PROCESS.
- DATE : YYMMDD-
- PACKAGING : TAPE & REEL

REV.	ECN NO OR DESCRIPTION	REVISED	DATE
A	PDR NO:T141028-3A	Edi.Zhou	2015.06.11
B	ECN NO:S151026-C	PENG	2015.11.28
C	ECN NO:S160306-C	PENG	2016.03.08

Recommended P.C.B Layout (THICKNESS=1.0mm)
(Component Side) TOLERANCE=±0.03 TOP VIEW

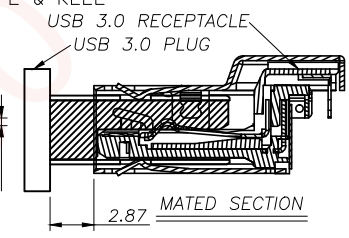
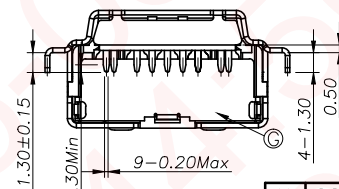
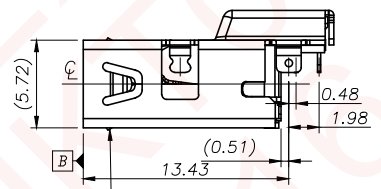
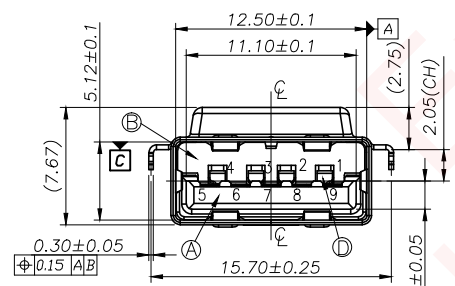

Pin Number	Signal ASSIGNMENT
PIN 1	VBUS
PIN 2	D-
PIN 3	D+
PIN 4	GND
PIN 5	StdA_SSRX-
PIN 6	StdA_SSRX+
PIN 7	GND_DRAIN
PIN 8	StdA_SSTX-
PIN 9	StdA_SSTX+

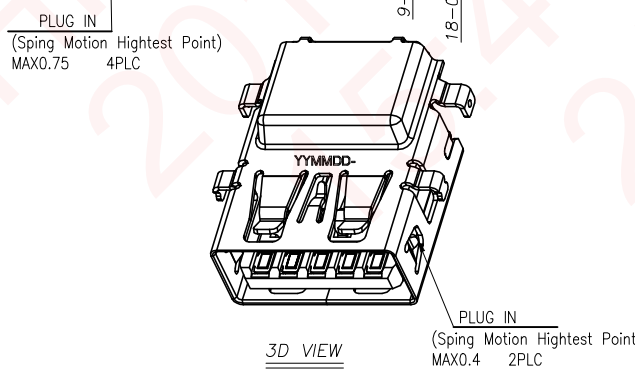
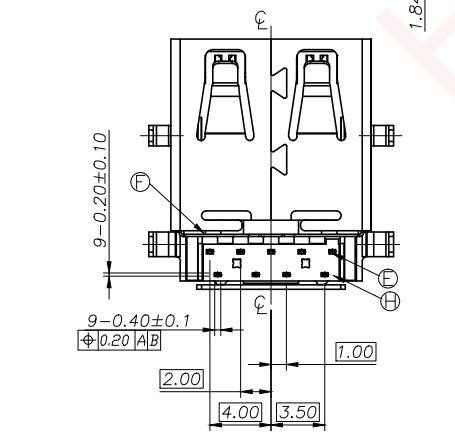

H	COVER	1	PA9T UL94V-0	BLACK
G	SHELL COVER	1	STAINLESS STEEL	
F	Mylar	1	L11*W4*TO.06	
E	TERMINAL	5	COOPER ALLOY	G/F PLATED ON MATING AREA. Matte Sn 100u" PLATED ON SOLDERING RO. NICKEL UNDER PLATING OVERALL
D	TERMINAL	4	COOPER ALLOY	G/F PLATED ON MATING AREA. Matte Sn 100u" PLATED ON SOLDERING RO. NICKEL UNDER PLATING OVERALL
C	SHELL	1	STAINLESS STEEL	NICKEL 60u" MIN
B	BASE	1	PA9T UL94V-0	BLACK
A	HOUSING	1	PA9T UL94V-0	BLACK
NO	DESCRIPTION	QTY	MATERIAL	PLATING & COLOR

UNLESS OTHERWISE SPECIFIED TOLERANCES		Singatron Enterprise Co., Ltd. 信音企業股份有限公司	
DECIMALS:	ANGLES:	TITLE USB 3.0 REVERSE CONNECTOR	
X : ±0.50	X : ±2°	DWN	PENG PART NO. 2UB4014-600101F
X.X : ±0.30	X.X : ±1°	CHKD	JAMES SCALE 1:1 UNIT: mm
X.XX : ±0.20		APVD	BOYE SIZE: A3 SHEET: 1 OF 1 REV: C
CUSTOMER COPY			

1 2 3 4 5 6 7 8 文件編號 RD-06-043-A