

1 2 3 4 5 6 7 8

F

E

D

C

B

A

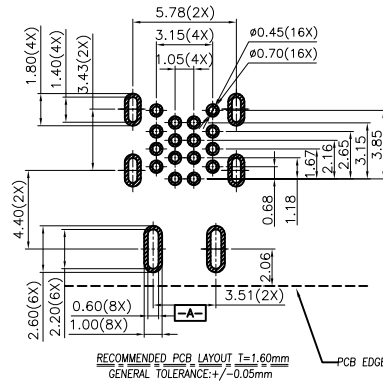
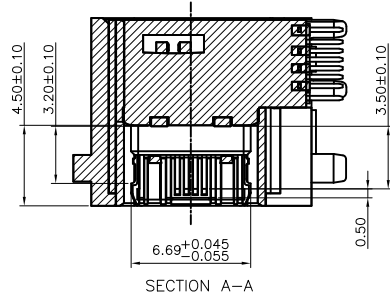
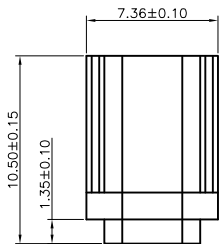

NOTE:

- Electrical Characteristics:
 - 1-1: Current Rating: 5A For Pin(A4,A9,B4,B9)
1.25A For Pin(B5)
0.25A For Others Pin
 - 1-2: VOLTAGE RATING:20V
 - 1-3: Insulation Resistance: 100MΩ Min.
 - 1-4: Contact Resistance:
VBUS & GND PINS AND OTHER PINS: 40mΩ/PIN MAX.
SHIELD:50mΩ/MAX.
SHIELD:LLCR MAX. CHANGE OF ALL PINS: 10mΩ.
 - 1-5: Dielectric Withstanding Voltage: 100V/AC 1Minute
- Mechanical Characteristics:
 - Insertion Force: 5~20N
 - Extraction Force: Initial: 8~20N
After durability: 6~20N
 - Durability :10000 Cycles
- Operating Temperature: -25°C TO +85°C

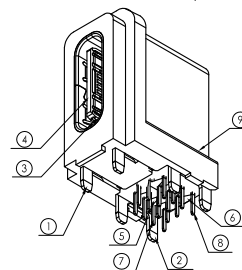
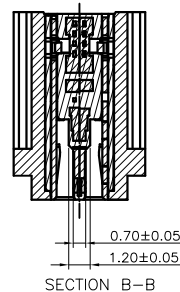
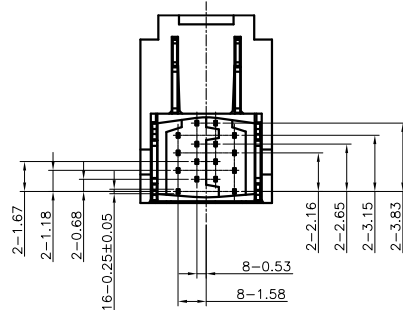
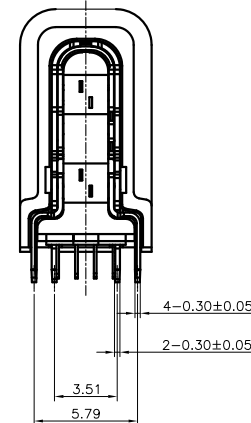
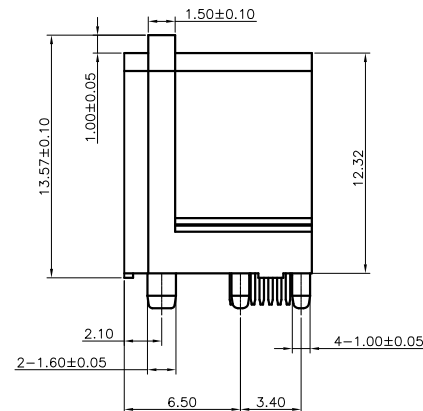
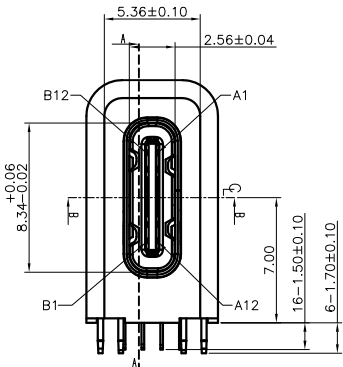

PIN ASSIGNMENT											
A1	A2	A3	A4	A5	A6	A7	A8	A9	A10	A11	A12
GND			VBUS	CC1	Dp1	Dn1	SBU1	VBUS			GND
GND			VBUS	SBU2	Dn2	Dp2	CC2	VBUS			GND
B12	B11	B10	B9	B8	B7	B6	B5	B4	B3	B2	B1
⑨ Jacket	1		LCP E130i,UL94 V-0		Black						
⑧ Up Terminal	12		C7025-TM02,T=0.15		Contact Area:Pd Ni 0.30um Min, Au Solder Area:Au 0.05um Min Ni 2.0-5.0um over all						
⑦ Down Terminal	12										
⑥ Up Moding	1										
⑤ Down Moding	1		LCP E130i,UL94 V-0		Black						
④ Second Moding	1										
③ 中夹片	1		SUS301-H,T=0.20		Ni 1.0-5.0um Underplating						
② 内壳	1		SUS304-3/4H,T=0.30		Ni 1.0-5.0um Underplating						
① 外壳	1		SUS304-3/4H,T=0.30		Ni 1.0-5.0um Underplating						
NO.	NAME	QT	Y	MATERIAL	PLATING						

UNLESS OTHERWISE SPECIFIED TOLERANCES				Singatron Enterprise Co., Ltd.			
DECIMALS:		ANGLES:		TITLE	Type C 16PIN 防水型		
DIM	TOL	DIM	TOL	DWN	Tony	PART NO. 2UC16W-1333-000H	
X.	±0.50	X.	±2°	CHKD	2021.4.27	SCALE 1:1	UNIT: mm
X.X	±0.30	X.X	±1°	APVD	Andy	SIZE: A3	SHEET:1 OF 2
X.XX	±0.20	X.XX	///	REV: A1			
X.XXX	±0.10	X.XXX	///	CUSTOMER COPY			

1 2 3 4 5 6 7 8

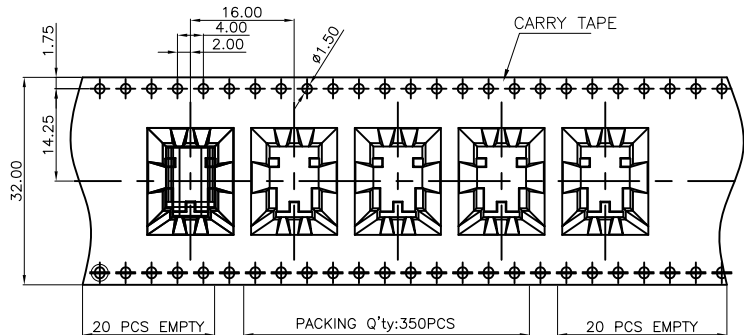
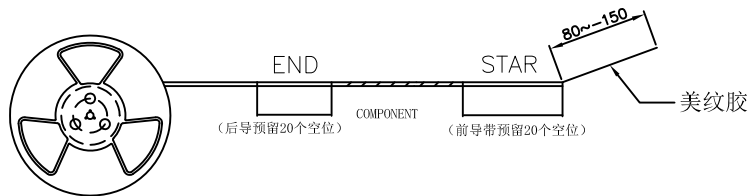

拉出方向

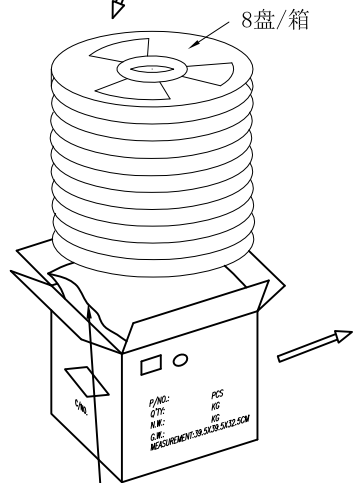
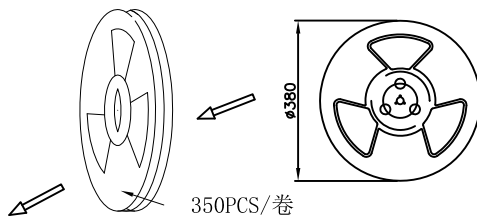
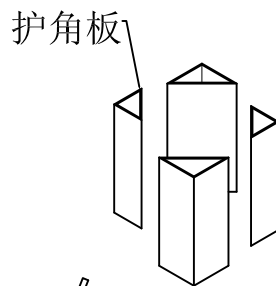
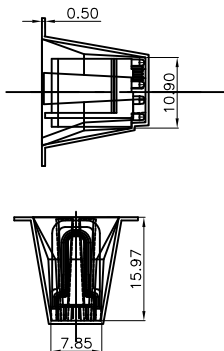

PE袋
外箱内要加气泡袋

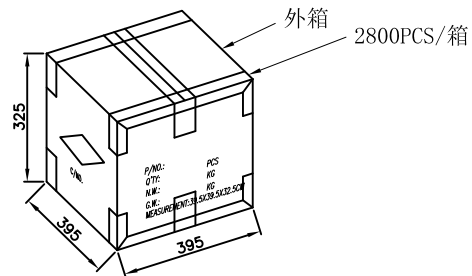

备注:

1. 包材规格:

- 纸板: 382*382*6mm A=A
- 白色纸盘: $\phi 380$ *W32mm
- 卷带: 390PCS空格/卷 透明防静电PET
- 三角纸板: 155*110*300mm,A=A
- 自粘式上带: W=25.5*T=0.08mm
- PE袋: 600*700
- 外箱: 395*395*325mm(内径) K=K

- 2. 将产品依左图所示装入载带中, 产品前空20空格、后空20格; 再将上带与载带粘好, 绕完后用80-150mm长度的美纹胶粘在载带上, 350pcs/卷盘, 每卷盘都需贴卷盘装标签。
- 3. 将8个卷盘放入1个大PE防水袋, 再将护角板装入外箱, 共计2800pcs/外箱。
- 4. 将装好产品外箱用透明胶带封成“工”形, 并在外箱左上角贴无卤标签, 物料标识区分用的“外箱标签”。

UNLESS OTHERWISE SPECIFIED TOLERANCES				Singatron Enterprise Co., Ltd.			
DECIMALS:		ANGLES:		TITLE	Type C 16PIN 防水型		
DIM	TOL	DIM	TOL	DWN	Tony	PART NO. 2UC16W-1333-000H	
X.	±0.50	X.	±2°	CHKD	2021. 4. 27	SCALE 1:1	UNIT: mm
X.X	±0.30	X.X	±1°	APVD	Andy	SIZE: A3	SHEET: 2 OF 2
X.XX	±0.20	X.XX		REV: A1			
X.XXX	±0.10	X.XXX		CUSTOMER COPY			