

- NOTE:
- Material:
 - All Housing: LCP(Polyplastics),Black,Thermoplastics,UL94V-0
 - Insulation Jacket: LCP(Polyplastics),Black,Thermoplastics,UL94V-0
 - Contact: Copper Alloy
 - Mid Plate: Stainless Steel
 - Outer Shell: Stainless Steel
 - Inner Shell: Stainless Steel
 - FINISH:
 - Contact: Au 2u" Min. over Pd-Ni 30u" Min. on Contact Area
 - Au 2u" Min. on Solder Area
 - 80~200u" Nickel Underplating Over All
 - Mid-Plate: 40~200u" Nickel Over All
 - Inner & Outer Shell: 40~200u" Nickel Over All
 - Outer Shell (Insulator) Minimum Thickness 0.40mm
 - Electrical Characteristics:
 - Current Rating: 5A For Pin(A4,A9,B4,B9)
 - 1.25A For Pin(A1,A12,B1,B12,B5)
 - 0.25A For Others Pin
 - Insulation Resistance: 100MΩ Min.
 - Contact Resistance: 40 mΩ Max. Before the test
 - 50 mΩ Max. After the test
 - Dielectric Withstanding Voltage: 500V/AC/0.1S/0.1m
 - Mechanical Characteristics:
 - Insertion Force: 5~20N
 - Extraction Force: Initial: 8~20N
 - After durability: 6~20N
 - Durability :10000 Cycles
 - Operating Temperature: -45°C TO +85°C
 - IP RATING: IP45

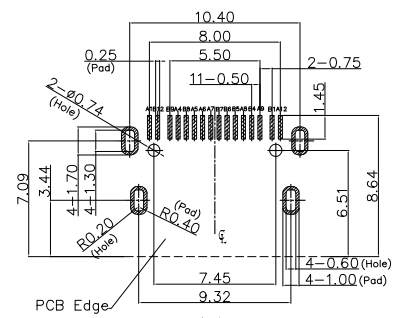
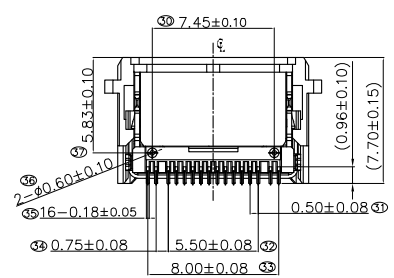
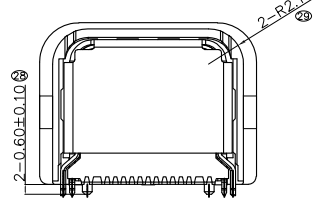
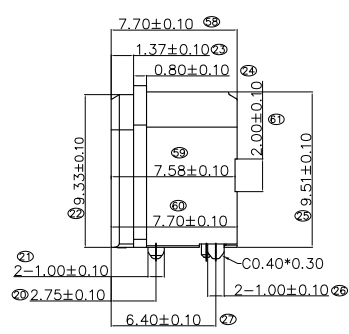
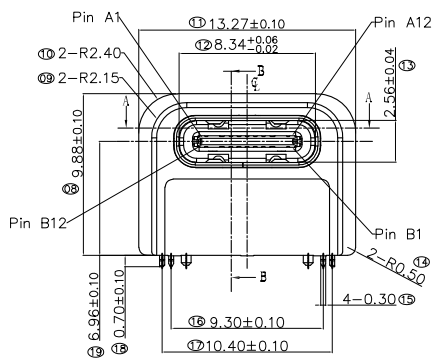

Recommended PCB Layout
General Tolerance ±0.05
■ Pad Area
Top View

PIN ASSIGNMENT			
PIN NO.	SIGNAL NAME	PIN NO.	SIGNAL NAME
A1	GND	B12	GND
A2		B11	
A3		B10	
A4	VBUS	B9	VBUS
A5	CC1	B8	SBU2
A6	D+	B7	D-
A7	D-	B6	D+
A8	SBU1	B5	CC2
A9	VBUS	B4	VBUS
A10		B3	
A11		B2	
A12	GND	B1	GND

NO.	NAME	MATERIAL	QTY
9	UP TERMINAL	C18400	8
8	DOWN TERMINAL	C18400	8
7	INSULATION JACKET	LCP E130i	1
6	DOWN MOLDING	BLACK	1
5	UP MOLDING	UL 94V-0	1
4	SECOND MOLDING		1
3	MID-PLATE	SUS 301	1
2	INNER SHELL	SUS 304	1
1	OUTER SHELL	SUS 304	1

UNLESS OTHERWISE SPECIFIED TOLERANCES

DECIMALS:		ANGLES:	
DIM	TOL	DIM	TOL
X.	±0.50	X.	±2°
X.X	±0.30	X.X	±1°
X.XX	±0.20	X.XX	±1'
X.XXX	±0.10	X.XXX	///

Singatron Enterprise Co., Ltd.

TITLE	USB TYPE C 16PIN Waterproof		
DWN	Tony	PART NO.	2UC16W-1570-000H
CHKD	2022.9.9	SCALE 1:1	UNIT: mm
APVD	Andy	SIZE: A3	SHEET: 1 OF 2
REV: A1			
CUSTOMER COPY			

1 2 3 4 5 6 7 8

F

E

D

C

B

A

F

E

D

C

B

A

产品的拉出方向(包装后)

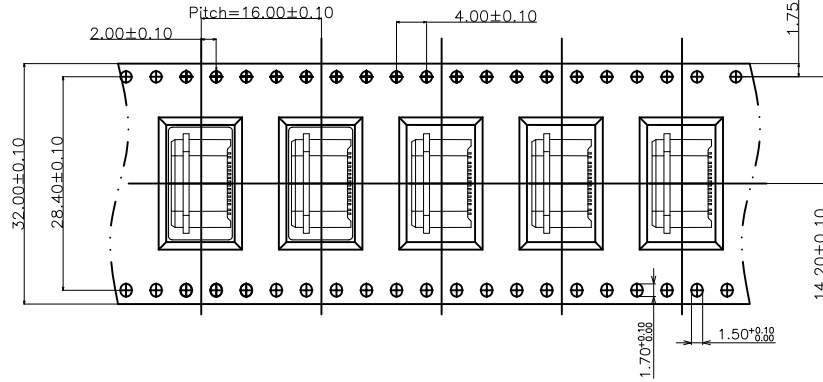

盘面标签

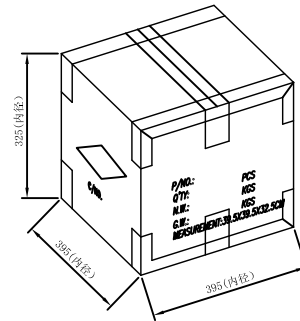
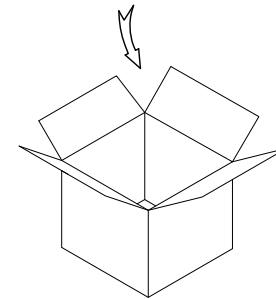
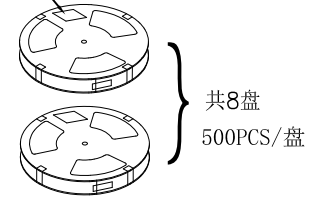

4000PCS/8盘/箱

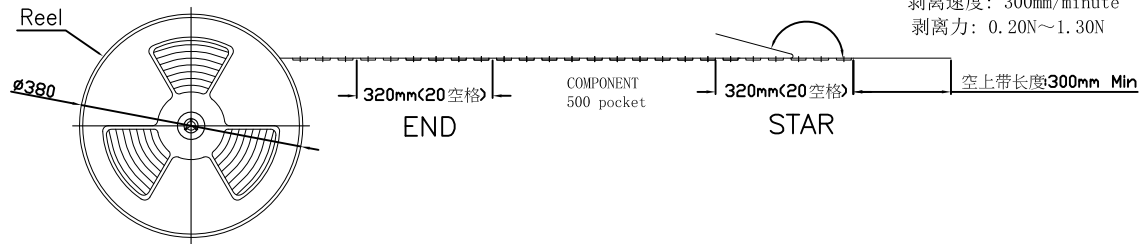

上带剥离角度: 165° ~ 180°
剥离速度: 300mm/minute
剥离力: 0.20N~1.30N

UNLESS OTHERWISE SPECIFIED TOLERANCES

DECIMALS:		ANGLES:	
DIM	TOL	DIM	TOL
X.	±0.50	X.	±2°
X.X	±0.30	X.X	±1°
X.XX	±0.20	X.XX	///
X.XXX	±0.10	X.XXX	///

Singatron Enterprise Co., Ltd.

TITLE	USB TYPE C 16PIN Waterproof		
DWN	Tony	PART NO. 2UC16W-1570-000H	
CHKD	2022.9.9	SCALE 1:1	UNIT: mm
APVD	Andy	SIZE: A3	SHEET: 2 OF 2

CUSTOMER COPY

1 2 3 4 5 6 7 8