

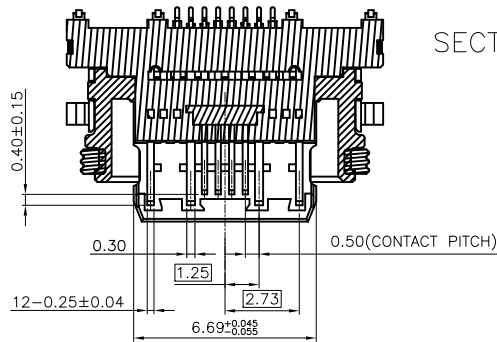

**RoHS Compliant HSF**  
2013/95/EC

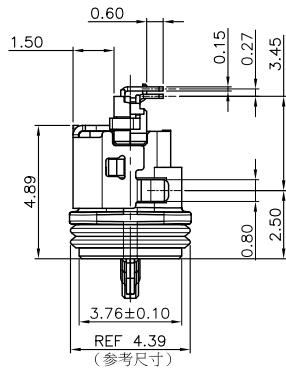

SECTION B-B

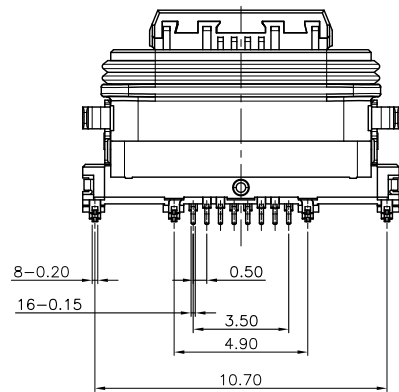
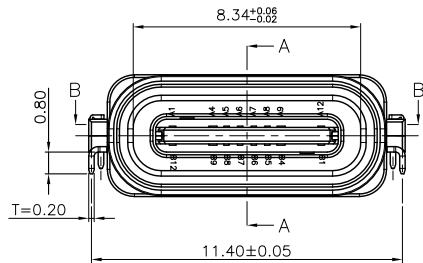
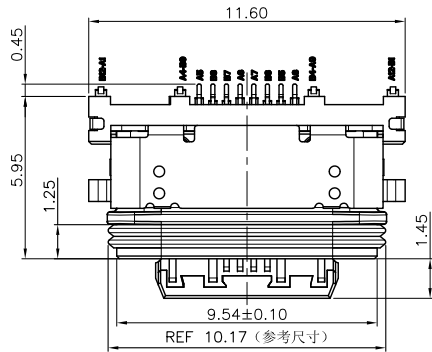
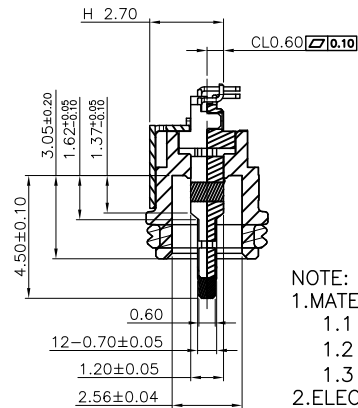
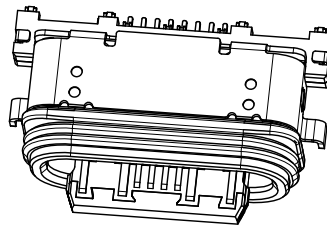

SECTION A-A

NOTE:

1. MATERIAL:

- 1.1 INSULATOR: HIGH TEMPERATURE PLASTIC UL 94 V-0;
- 1.2 CONTACT: COPPER ALLOY(T=0.15mm)
- 1.3 SHELL: STAINLESS STEEL(T=0.20mm)

2. ELECTRICAL CHARACTERISTICS:

- 2.1 CONTACT RESISTANCE: 40mΩ Max FOR INITIAL. 10mΩ CHANGE AFTER TEST. MEASURE AT 20mV, 100mA.
- 2.2 CONTACT CURRENT RATING: 5A FOR COLLECTIVELY POWER SUPPLY PIN(PINA1,A4,A9,A12,B1,B4,B9,B12); 1.25A FOR V<sub>CONN</sub> PIN; 0.25A FOR OTHER SIGNAL PIN.
- 2.3 DIELECTRIC WITHSTANDING VOLTAGE: 100V AC R.M.S.
- 2.4 INSULATION RESISTANCE 100MΩ Min
- 2.5 OPERATING TEMPERATURE: -40°C ~ 85°C

3. MECHANICAL CHARACTERISTICS:

- 3.1 INSERTION FORCE: 5~20 N.
- 3.2 EXTRACTION FORCE: 8~20N AFTER TEST
- 3.3 DURABILITY: 10,000 CYCLES
- 3.4 THE EXTRACTION FORCE SHALL BE WITHIN THE RANGE OF 6N~20N AFTER 10000.

4. PLATING

- 4.1 TERMINAL CONTACT: (SEE TAB) GOLD PLATING ALL OVER 50u" Min NICKEL AND 80u" Min Tin ALL OVER 50u" Min NICKEL ON SOLDER AREA
- 4.2 OUT SHELL: 50u" Min. NICKEL ALL OVER
- 4.3 INNER SHELL: 50u" Min. NICKEL ALL OVER

5. PART NUMBER:

2UC16W-21X02-24A

- 1: G/F
- 2: 5u"
- 3: 10u"
- 4: 15u"
- 5: 30u"

Pin	Signal Name	Mating Sequence	Pin	Signal Name	Mating Sequence
A1	GND	First	B12	GND	First
A4	V <sub>BUS</sub>	First	B9	V <sub>BUS</sub>	First
A5	CC1	Second	B8	SBU2	Second
A6	Dp1	Second	B7	Dn2	Second
A7	Dn1	Second	B6	Dp2	Second
A8	SBU1	Second	B5	CC2	Second
A9	V <sub>BUS</sub>	First	B4	V <sub>BUS</sub>	First
A12	GND	First	B1	GND	First
SHELL	GND		SHELL	GND	

TOLERANCES UNLESS OTHERWISE SPECIFIED

UNIT	(MM)
X.	±0.50
X.X	±0.30
X.XX	±0.20
X.XXX	±0.10
ANGEL	±2'

Singatron Enterprise Co., Ltd.

TITLE	USB CF 2.0 WATERPROOF CL0.60 SMT TYPE FOR IPX8 WOL			
DWN	Rain	PART NO.	2UC16W-21X02-24A	
CHKD	2022.09.05	SCALE	1:1	UNIT: mm
APVD	FCC	SIZE: A3	SHEET: 1 OF 3	REV: A

CUSTOMER COPY

REV.	DESCRIPTION	ECN NO.	DWN.	CHK.	APVD.	DATE
A	NEW DARWING	ECN NO.	Rain	Chain	DC	2022.09.05



**RoHS Compliant HSF**  
2013/95/EC

机壳面板

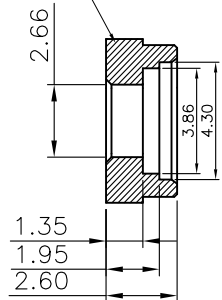

硅胶密封圈

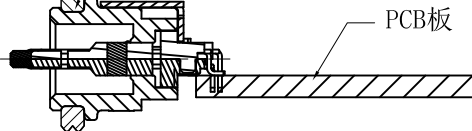

PCB板

组装方式，左右方向装配

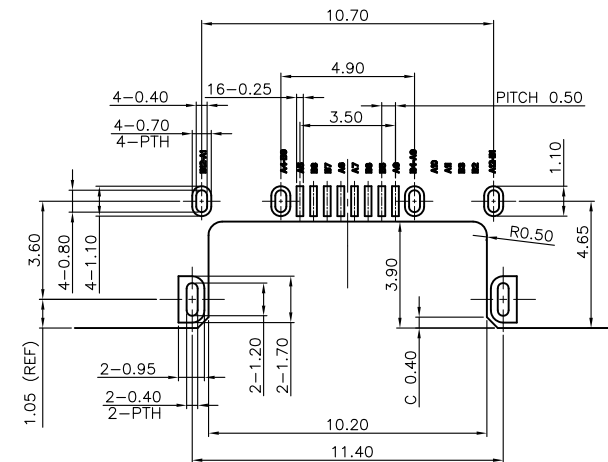

RECOMMEND P.C.B LAYOUT (COMPONENT SIDE)  
TOLERANCE FOR PCB LAYOUT IS  $\pm 0.05$

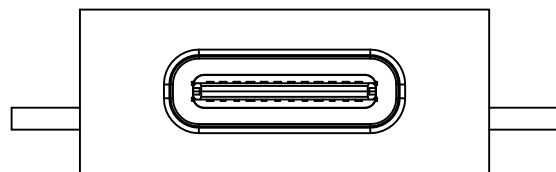

机壳面板与密封圈  
建议压缩量50%Min

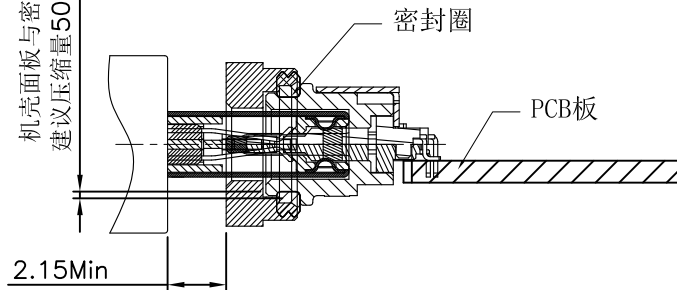

密封圈

PCB板

组装面板后公母头对插示意图

REV.	DESCRIPTION	ECN NO.	DWN.	CHK.	APVD.	DATE
A	NEW DARWING	ECN NO.	Rain	Chain	DC	2022.09.05

TOLERANCES UNLESS OTHERWISE SPECIFIED	
UNIT	(MM)
X.	$\pm 0.50$
X.X	$\pm 0.30$
X.XX	$\pm 0.20$
X.XXX	$\pm 0.10$
ANGEL	$\pm 2'$

Singatron Enterprise Co., Ltd.

TITLE	USB CF 2.0 WATERPROOF CL0.60 SMT TYPE FOR IPX8 WOL		
DWN	Rain	PART NO.	2UC16W-21X02-24A
CHKD	2022.09.05	SCALE	1:1 UNIT: mm
APVD	FCC	SIZE: A3	SHEET: 2 OF 3 REV: A

CUSTOMER COPY

38.4  
32.4

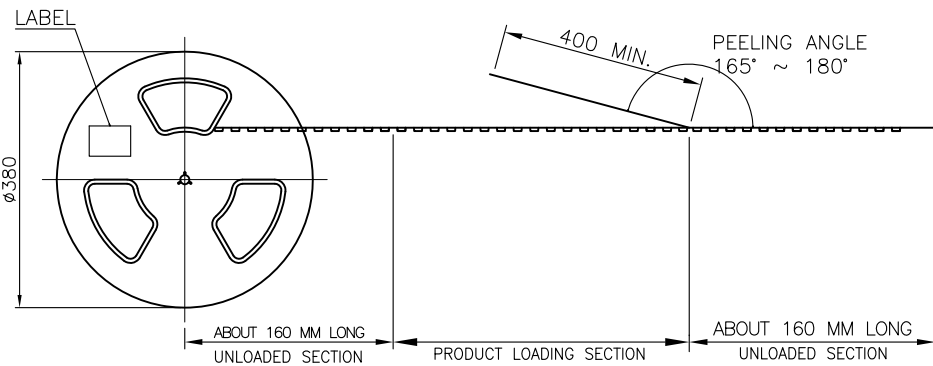

USER DIRECTION OF UNREELING

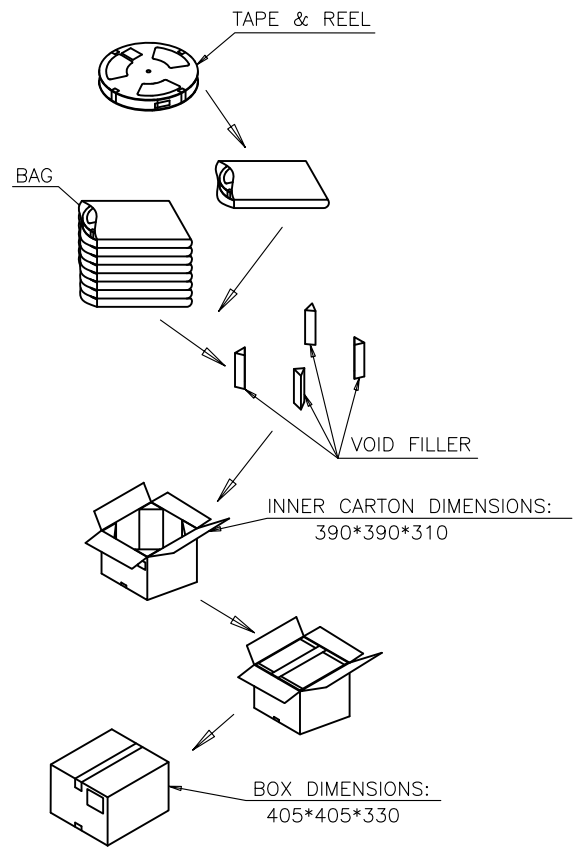
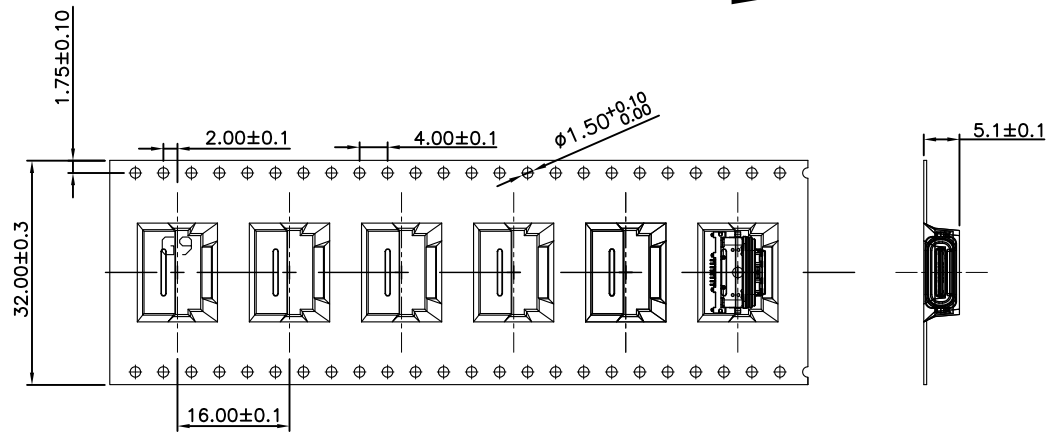

NOTE:

- 1.MATERIAL:  
BOX: FIBREBOARD, CORRUGATED, DOUBLE WALL.  
TAPE: POLYSTYRENES, HEAT-RESISTANT TEMPERATURE: 120°C, BLACK COLOR.  
REEL: POLYSTYRENES, HEAT-RESISTANT TEMPERATURE: 70°C, BLUE COLOR.  
BAG: POLYETHYLENE, HEAT-RESISTANT TEMPERATURE: 100°C.

2.PEELING STRENGTH: 0.1 ~ 1.3 N (10 ~ 130 GRAMS)

3.PEELING SPEED: 300 mm/min.

4.EACH BAG SHALL BE INCLUDED DESICCANT.

1000	8	8000 PCS	-- KG	-- KG
PCS/ REEL	REELS/ CARTON	QUANTITY	GROSS WEIGHT	NET WEIGHT

Singatron Enterprise Co., Ltd.

REV.	DESCRIPTION	ECN NO.	DWN.	CHK.	APVD.	DATE
A	NEW DAWING	ECN NO.	Rain	Chain	DC	2022.09.05

TOLERANCES UNLESS OTHERWISE SPECIFIED	
UNIT	(MM)
X.	$\pm 0.20$
X.X	$\pm 0.15$
X.XX	$\pm 0.10$
X.XXX	$\pm 0.05$
ANGEL	$\pm 1'$

TITLE	USB CF 2.0 WATERPROOF CLO.60 SMT TYPE FOR IPX8 WOL			
DWN	Rain	PART NO.	2UC16W-21X02-24A	
CHKD	2022.09.05	SCALE	1:1	UNIT: mm
APVD	FCC	SIZE:	A3	SHEET: 3 OF 3
REV: A				

CUSTOMER COPY