

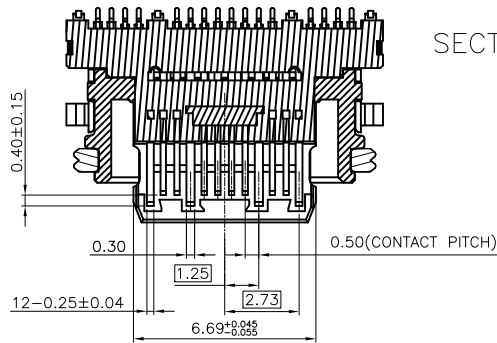

RoHS Compliant HSF
2013/95/EC

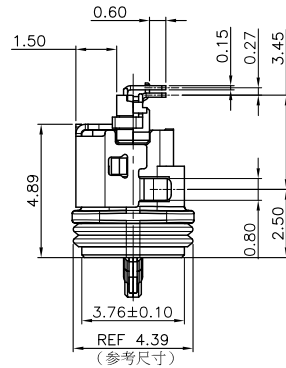

SECTION B-B

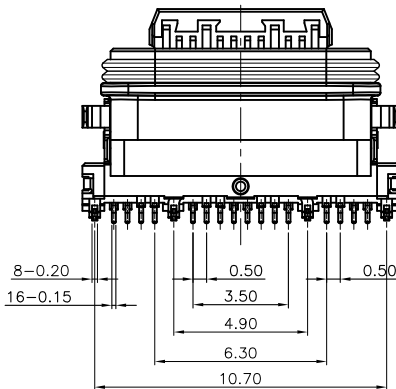
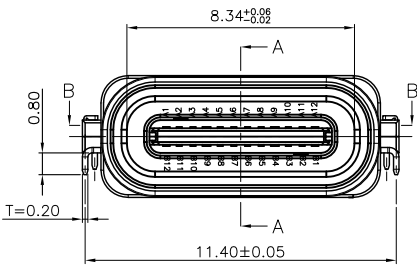
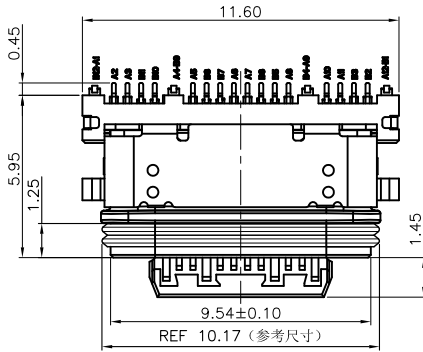
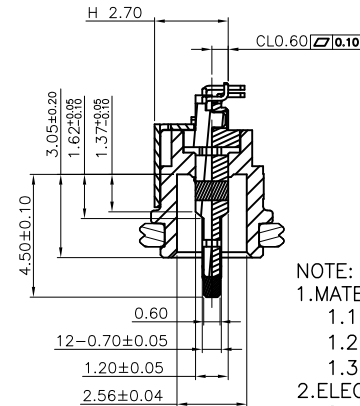
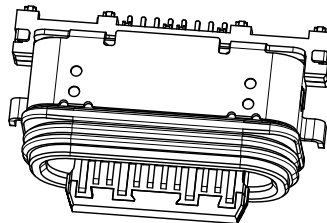

SECTION A-A

NOTE:

1. MATERIAL:

- 1.1 INSULATOR: HIGH TEMPERATURE PLASTIC UL 94 V-0;
- 1.2 CONTACT: COPPER ALLOY(T=0.15mm)
- 1.3 SHELL: STAINLESS STEEL(T=0.20mm)

2. ELECTRICAL CHARACTERISTICS;

- 2.1 CONTACT RESISTANCE: 40mΩ Max FOR INITIAL. 10mΩ CHANGE AFTER TEST. MEASURE AT 20mV, 100mA.
 - 2.2 CONTACT CURRENT RATING: 5A FOR COLLECTIVELY POWER SUPPLY PIN(PINA1,A4,A9,A12,B1,B4,B9,B12); 1.25A FOR V_{CONN} PIN; 0.25A FOR OTHER SIGNAL PIN.
 - 2.3 DIELECTRIC WITHSTANDING VOLTAGE: 100V AC R.M.S.
 - 2.4 INSULATION RESISTANCE 100MΩ Min
 - 2.5 OPERATING TEMPERATURE: -40°C ~ 85°C
3. MECHANICAL CHARACTERISTICS:
- 3.1 INSERTION FORCE: 5~20 N.
 - 3.2 EXTRACTION FORCE: 8~20N AFTER TEST
 - 3.3 DURABILITY: 10,000 CYCLES
 - 3.4 THE EXTRACTION FORCE SHALL BE WITHIN THE RANGE OF 6N~20N AFTER 10000.

4. PLATING

- 4.1 TERMINAL CONTACT: (SEE TAB) GOLD PLATING ALL OVER 50u" Min NICKEL AND 80u" Min Tin ALL OVER 50u" Min NICKEL ON SOLDER AREA
- 4.2 OUT SHELL: 50u" Min. NICKEL ALL OVER
- 4.3 INNER SHELL: 50u" Min. NICKEL ALL OVER

5. PART NUMBER:

2UC24W-21X07-23A

- 1: G/F 2: 5u" 3: 10u"
- 4: 15u" 5: 30u"

Pin	Signal Name	Mating Sequence	Pin	Signal Name	Mating Sequence
A1	GND	First	B12	GND	First
A2	SSTXp1	Second	B11	SSRXp1	Second
A3	SSTXn1	Second	B10	SSRXn1	Second
A4	V _{BUS}	First	B9	V _{BUS}	First
A5	CC1	Second	B8	SBU2	Second
A6	Dp1	Second	B7	Dn2	Second
A7	Dn1	Second	B6	Dp2	Second
A8	SBU1	Second	B5	CC2	Second
A9	V _{BUS}	First	B4	V _{BUS}	First
A10	SSRXn2	Second	B3	SSTXn2	Second
A11	SSRXp2	Second	B2	SSTXp2	Second
A12	GND	First	B1	GND	First
SHELL	GND		SHELL	GND	

REV.	DESCRIPTION	ECN NO.	DWN.	CHK.	APVD.	DATE
A	NEW DARWING	ECN NO.	Rain	Chain	DC	2022.09.05

TOLERANCES UNLESS OTHERWISE SPECIFIED

UNIT	(MM)
X.	±0.50
X.X	±0.30
X.XX	±0.20
X.XXX	±0.10
ANGEL	±2'

Singatron Enterprise Co., Ltd.

TITLE	USB4.0 CF WATERPROOF CLO.60 SMT TYPE FOR IPX8 WOL				
DWN	Rain	PART NO.	2UC24W-21X07-23A		
CHKD	2022.09.05	SCALE	1:1	UNIT:	mm
APVD	FCC	SIZE:	A3	SHEET:	1 OF 3
		REV:	A		

CUSTOMER COPY



RoHS Compliant HSF
2013/95/EC

机壳面板

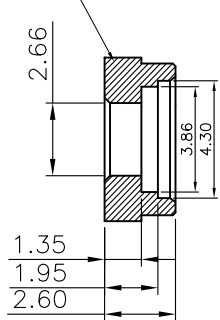

硅胶密封圈

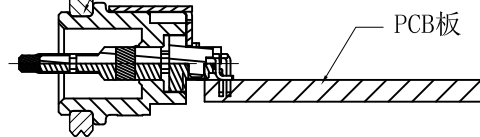

PCB板

组装方式，左右方向装配

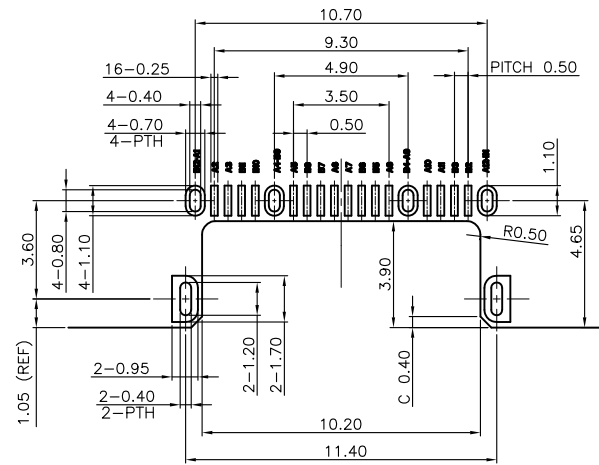

RECOMMEND P.C.B LAYOUT (COMPONENT SIDE)

TOLERANCE FOR PCB LAYOUT IS ± 0.05

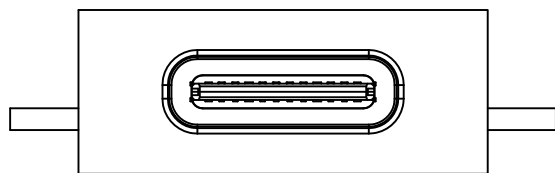

机壳面板与密封圈
建议压缩量50%Min

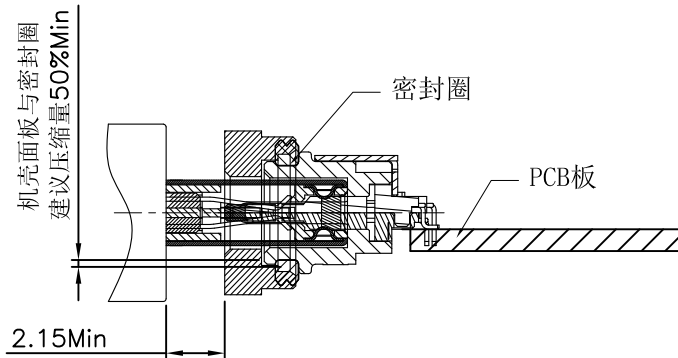

密封圈

PCB板

组装面板后公母头对插示意图

A	NEW DARWING	ECN NO.	Rain	Chain	DC	2022.09.05
REV.	DESCRIPTION	ECN NO.	DWN.	CHK.	APVD.	DATE

TOLERANCES UNLESS OTHERWISE SPECIFIED

UNIT	(MM)
X.	± 0.50
X.X	± 0.30
X.XX	± 0.20
X.XXX	± 0.10
ANGEL	$\pm 2'$

Singatron Enterprise Co., Ltd.

TITLE	USB4.0 CF WATERPROOF CLO.60 SMT TYPE FOR IPX8 WOL			
DWN	Rain	PART NO.	2UC24W-21X07-23A	
CHKD	2022.09.05	SCALE	1:1	UNIT: mm
APVD	FCC	SIZE: A3	SHEET: 2 OF 3	REV: A

CUSTOMER COPY

38.4
32.4

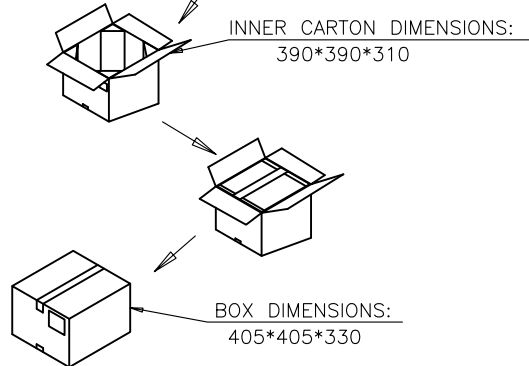
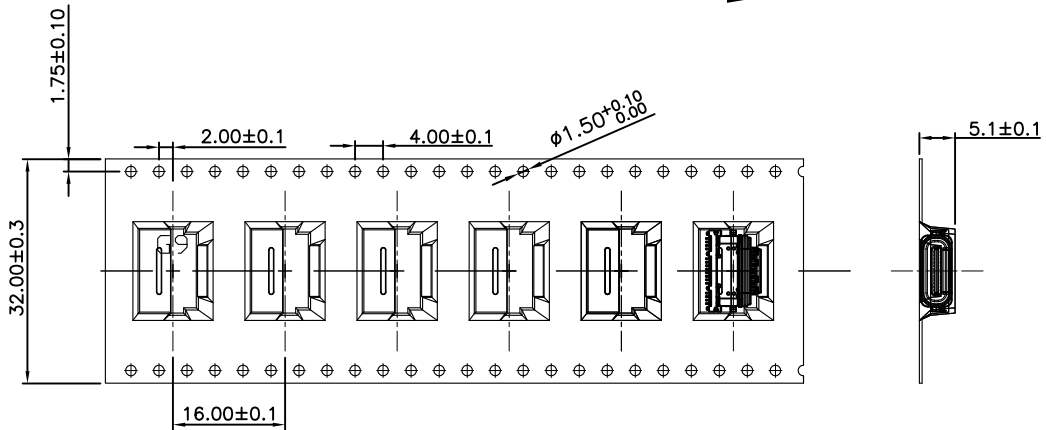
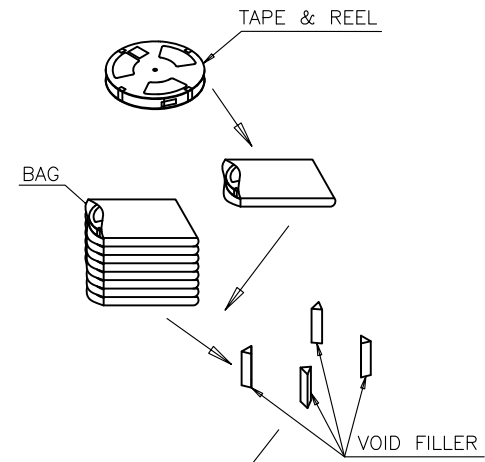
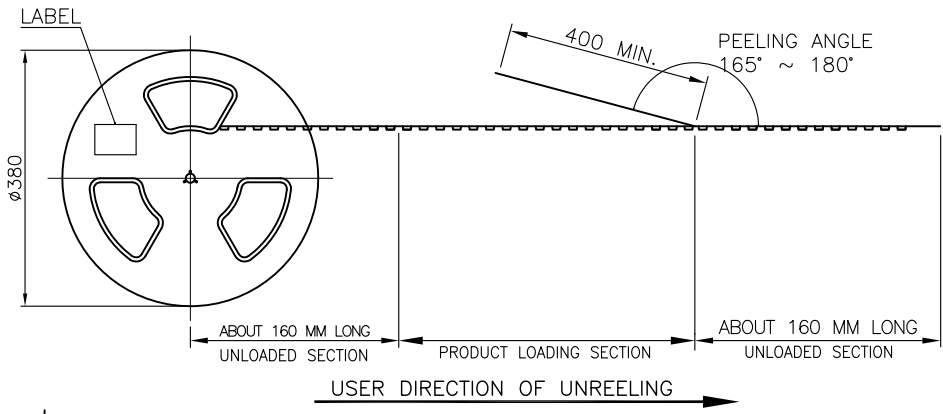

NOTE:

- MATERIAL:
BOX: FIBREBOARD, CORRUGATED, DOUBLE WALL.
TAPE: POLYSTYRENES, HEAT-RESISTANT TEMPERATURE: 120°C, BLACK COLOR.
REEL: POLYSTYRENES, HEAT-RESISTANT TEMPERATURE: 70°C, BLUE COLOR.
BAG: POLYETHYLENE, HEAT-RESISTANT TEMPERATURE: 100°C.
- PEELING STRENGTH: 0.1 ~ 1.3 N (10 ~ 130 GRAMS)
- PEELING SPEED: 300 mm/min.
- EACH BAG SHALL BE INCLUDED DESICCANT.

1000	10	8000 PCS	-- KG	-- KG
PCS/ REEL	REELS/ CARTON	QUANTITY	GROSS WEIGHT	NET WEIGHT

Singatron Enterprise Co., Ltd.

REV.	DESCRIPTION	ECN NO.	DWN.	CHK.	APVD.	DATE
A	NEW DAWING	ECN NO.	Rain	Chain	DC	2022.09.05

TOLERANCES UNLESS OTHERWISE SPECIFIED

UNIT	(MM)
X.	±0.20
X.X	±0.15
X.XX	±0.10
X.XXX	±0.05
ANGEL	±1°

TITLE	USB4.0 CF WATERPROOF CL0.60 SMT TYPE FOR IPX8 WOL			
DWN	Rain	PART NO.	2UC24W-21X07-23A	
CHKD	2022.09.05	SCALE	1:1	UNIT: mm
APVD	FCC	SIZE:	A3	SHEET: 3 OF 3
REV: A				
CUSTOMER COPY				