

REV	ZONE	REVISION	DATE

**Green Product**

**Specification:**  
 Contact Resistance: 30m Ohm Max.  
 Insulation Resistance: 1000M Ohm Min. At 500VDC.  
 Rated Voltage And Current: 1.5A At 250VAC Minimum.  
 Dielectric Withstanding Voltage:  
     500V AC (rms) for 1 Minute(Rev. 2.0)  
 Durability (Life Test): 1500 Cycles  
 Insertion Force: 35 Newton Maximum.  
 Extraction Force: 10 Newton Minimum.

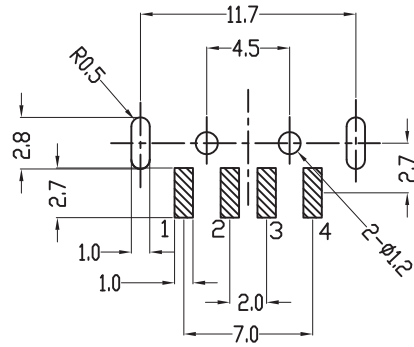
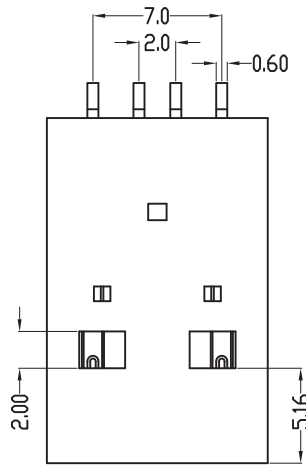

COMPONENT SIDE  
(PCB LAYOUT)

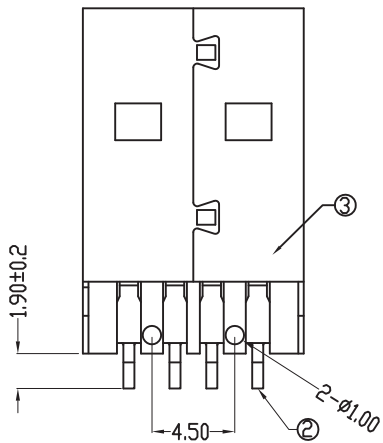
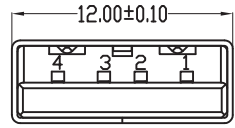
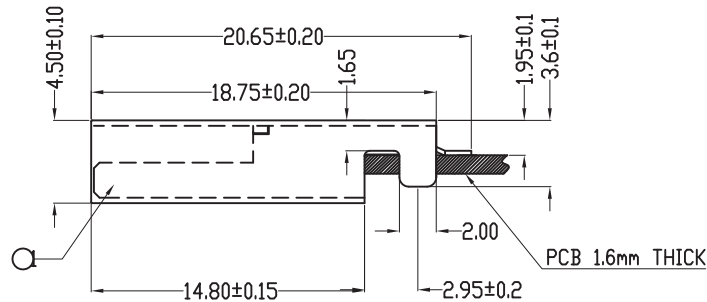

NO.	NAME	MATERIAL	FINISH	REMARK	Q'TY
1	HOUSING	NYLON PA9T G.F.	BLACK		1
2	PIN TERM.	BRASS EH T:0.25 mm	GOLD/TIN PLATED	Gold:30u" ; NI:40~60u" ; TIN:120u" (100% pure Tin of lead free plating)	4
3	SHELL	SPCC T:0.3 mm	NICKEL PLATED	NI:80~120u"	1

**SINGATRON U.S.A.**

COMPUTER NO.			UNIT	SCALE	PART NAME	
D:\DWG\KS-001MSK7-A1NBS(2.0)-L			mm	1:1	USB. TYPE A PLUG FLAT90° SMT	
APPD.	CKD.	DWG.	DATE	TOLERANCE	PART NO.	REV.
		TINA	25-02-10	X. ±0.38 .X ±0.25 .XX ±0.13 .XXX ±0.05	2UP-001MSK7A1NB2L	A0

MODEL 2UP-001MSK7A1NB2L PAGE 1 OF 1