

Recommended PCB Layout(Top View)

General tolerance±0.05

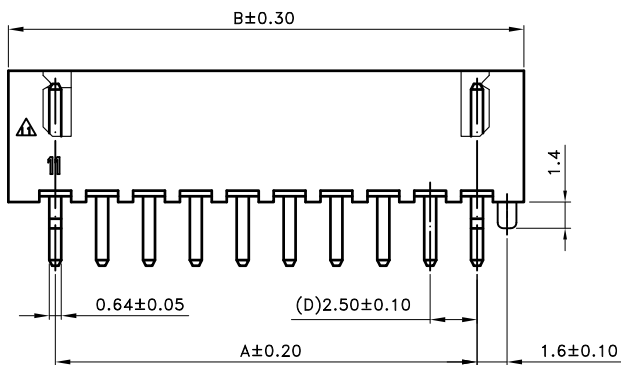

Poles	Dimension(mm)			Poles	Dimension(mm)		
	A	B	C		A	B	C
2	2.50	7.50	6.00	12	27.50	32.50	31.00
3	5.00	10.00	8.50	13	30.00	35.00	33.50
4	7.50	12.50	11.00	14	32.50	37.50	36.00
5	10.00	15.00	13.50	15	35.00	40.00	38.50
6	12.50	17.50	16.00	16	37.50	42.50	41.00
7	15.00	20.00	18.50	17	40.00	45.00	43.50
8	17.50	22.50	21.00	18	42.50	47.50	46.00
9	20.00	25.00	23.50	19	45.00	50.00	48.50
10	22.50	27.50	26.00	20	47.50	52.50	51.00
11	25.00	30.00	28.50				

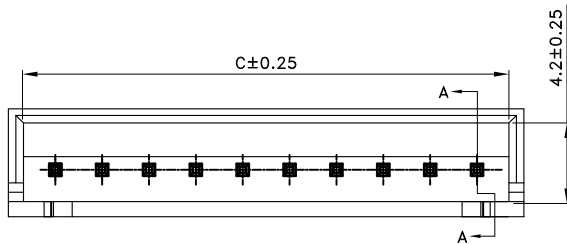
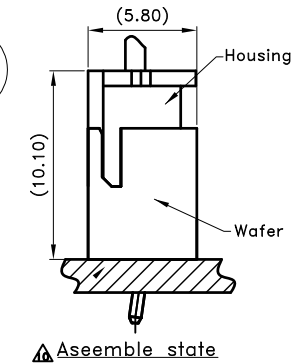
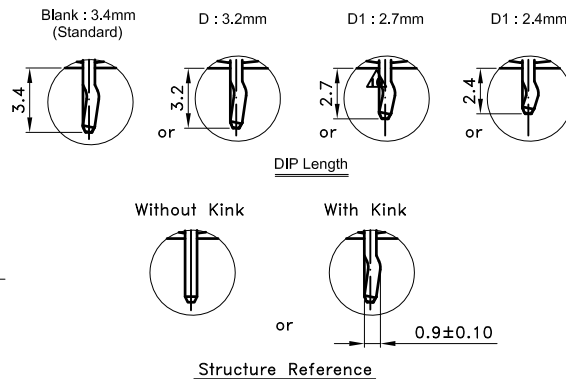
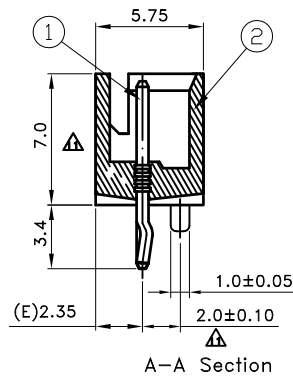
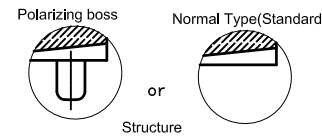
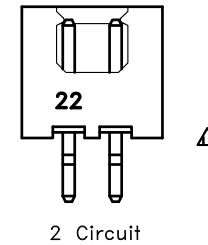
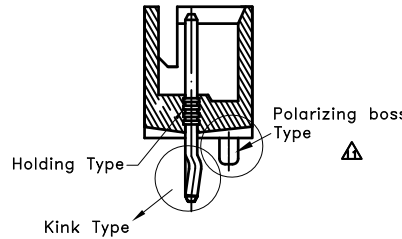

■ SPECIFICATIONS

- Rated Voltage : 250 V AC/DC
- Current Rating : 3A AC/DC.
- Withstanding Voltage : 1,000V AC/minute
- Insulation Resistance : 1,000MΩ min.
- Temperature Range : -25°C to +85°C
- Contact resistance : 20mΩ max.

■ WAFER

- Part No. : 2WB1001-XX X X XX X X (GF)XX

- ① Poles No : 2~20
- ② Structure1 : Blank : Normal Type(Standard)
P : Polarizing boss
- ③ Structure2 : Blank : Normal Type(Standard)
S : Holding Type
- ④ Plated Blank : Bright-Tin Plated
NM : Matte-Tin Plated
G : Gold Plated
- ⑤ Kink Type: Blank : Without Kink(standard)
K : With Kink
- ⑥ Dip Length: Blank : 3.4mm (standard)
D : 3.2mm
D1: 2.7mm
D2: 2.4mm
- ⑦ cover Base : Blank:Nylon 66 UL94V-0
GF : Nylon 66+15% G.F
- ⑧ Coler : Blank : Nature
R : Red(199C#)
R1 : Red(198C#)
BK : BLACK
BU : BLUE
Y : YELLOW
- ▲ Material : Contact : Brass
- ▲ Package : Bag

TOLERANCE	LTR	REVISION RECORD	NAME	DATE
.0	±0.30	▲ 全系列合併圖面	劉怡萱	2011/01/31
.00	±0.20	▲ 新增產品規格	周美麗	2012/12/26
.000	±0.10	▲ 修改材質說明	張逸維	2013/04/03
ANGLE		▲ 增加Dip Length: D1: 2.7mm及無齒標示	周家慶	2013/08/09
0°	±1°	▲ 修正圖面與實物一致,變更尺寸,增加顏色選項, D2尺寸	黃廣珍	2013/10/29
.0°	±	▲ 增加材質說明	藍美娜	2016/08/24
SHEET	1/1			

Singatron Enterprise Co., Ltd.

TITLE 2.50mm Disconnectable crimp style Wafer(Straight)

DWN 藍美娜 PART NO. 2WB1001-XX
 CHKD 周家慶 SCALE 1:1 UNIT: mm
 APVD 張育瑞 SIZE: A3 SHEET:1 OF 1 REV: a12

CUSTOMER COPY