

4~15 Circuit(Double Lock)

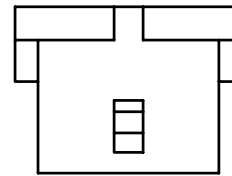

2~3 Circuit(Single Lock)

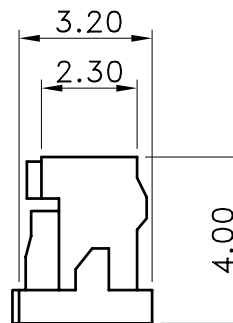
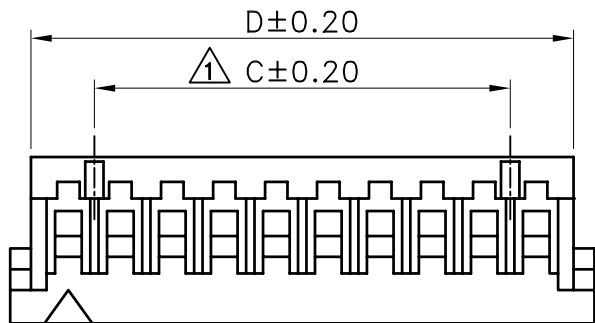
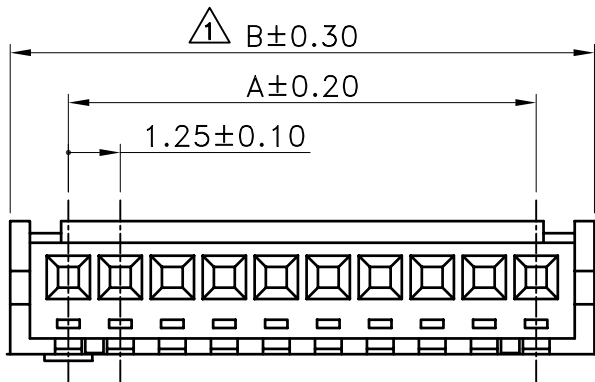

■ SPECIFICATIONS

- Current Rating : 1A AC/DC
- Withstanding Voltage : 500V AC/minute
- Insulation Resistance : 500M Ω min.
- Temperature Range : -35 $^{\circ}$ C to +85 $^{\circ}$ C
- Contact Resistance : 30m Ω max.

■ HOUSING

- Part No. : 2WB1245-XX
- Poles : 02~15
- Material : Nylon 66 UL94V-0
- Q' ty : 1,000 pcs./Bag

Poles	Dimensions(mm)			
	A	B	C	D
2	—	4.05	—	3.05
3	2.50	5.30	—	4.30
4	3.75	6.55	2.50	5.55
5	5.00	7.80	3.75	6.80
6	6.25	9.05	5.00	8.05
7	7.50	10.30	6.25	9.30
8	8.75	11.55	7.50	10.55
9	10.00	12.80	8.75	11.80
10	11.25	14.05	10.00	13.05
11	12.50	15.30	11.25	14.30
12	13.75	16.55	12.50	15.55
13	15.00	17.80	13.75	16.80
14	16.25	19.05	15.00	18.05
15	17.50	20.30	16.25	19.30

TOLERANCE		LTR	REVISION RECORD	NAME	DATE
.0	± 0.30	\triangle	ECR 201102-006	王誠賢	11/02/14
.00	± 0.20				
.000	± 0.10				
ANGLE					
0 $^{\circ}$	$\pm 1^{\circ}$				
.0 $^{\circ}$	\pm				

Singatron Enterprise Co., Ltd.

TITLE	1.25mm Wire to Board Connector			
DWN	王誠賢	PART NO.	2WB1245-XX	
CHKD	黃科源	SCALE 1:1	UNIT: mm	
APVD	張育瑞	SIZE: A3	SHEET: 1 OF 1	REV: a5

CUSTOMER COPY