

▲ Recommended PCB Layout

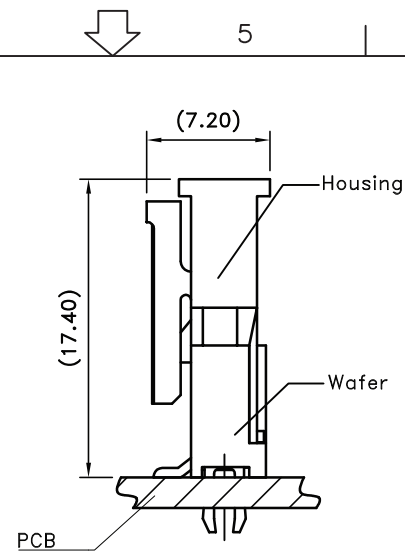

▲ Assemble state

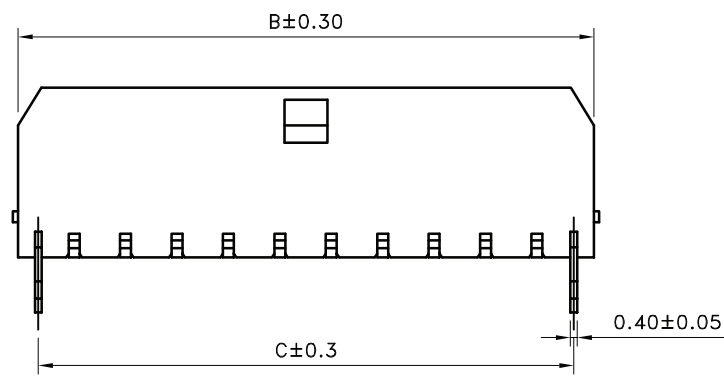
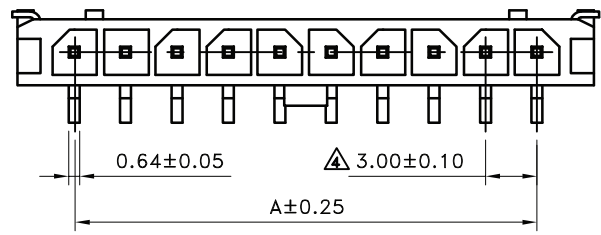
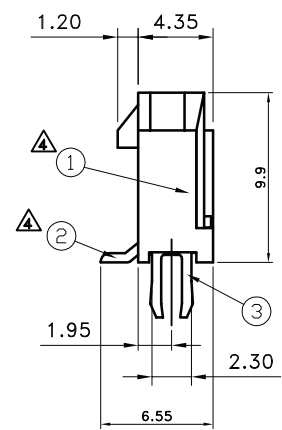

■ SPECIFICATIONS

- Current Rating : 5A AC/DC
- Withstanding Voltage : 1,500V AC/minute
- Insulation Resistance : 1,000M Ω min.
- Temperature Range : -40°C ~ +105°C
- Contact Resistance : 20m Ω max.

■ WAFER

- Part No. : 2WB3029SV-XX
- Poles : 2 - 12 (With Mount Clips)
- Material : 1.Base : LCP, UL 94V-0
2.Contacts : Brass
3.Clip:Brass
- Finish : 100u"Min Tin-Lead Plating.
50u"Min Nickel Under Plating.

Poles	Dimensions(mm)			Poles	Dimensions(mm)		
	A	B	C		A	B	C
2	3.00	9.70	7.30	8	21.00	27.70	25.30
3	6.00	12.70	10.30	9	24.00	30.70	28.30
4	9.00	15.70	13.30	10	27.00	33.70	31.30
5	12.00	18.70	16.30	11	30.00	36.70	34.30
6	15.00	21.70	19.30	12	33.00	39.70	37.30
7	18.00	24.70	22.30				

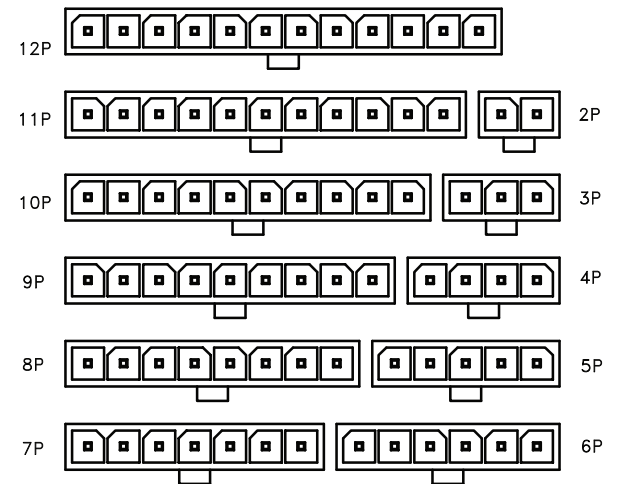

TOLERANCE	LTR	REVISION RECORD	NAME	DATE
.0	±0.30	▲ 200707-008	黃科源	07/07/06
.00	±0.20	▲ 200802-009	黃科源	08/02/18
.000	±0.10	▲ 200810-012	黃科源	08/10/30
ANGLE		▲ 環境溫度變更-40°C to +105°C	劉怡萱	2011/02/09
0°	±1°	▲		
.0°	±	▲		
SHEET	1/1	▲		

Singatron Enterprise Co., Ltd.

TITLE	3.0mm Mini Fit Single Row, Straight SMT Type			
DWN	劉怡萱	PART NO. 2WB3029SV-XX		
CHKD	黃科源	SCALE 1:1	UNIT: mm	⊕
APVD	張育瑞	SIZE: A3	SHEET: 1 OF 1	REV: a4
CUSTOMER COPY				