

Recommended PCB Layout

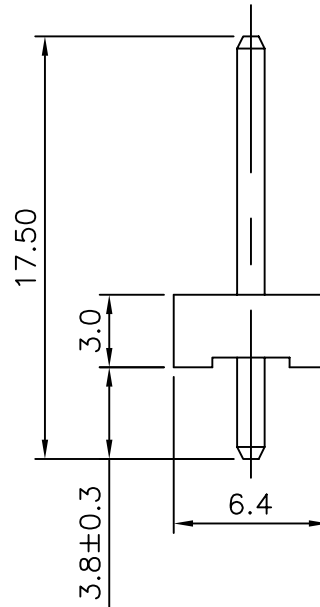
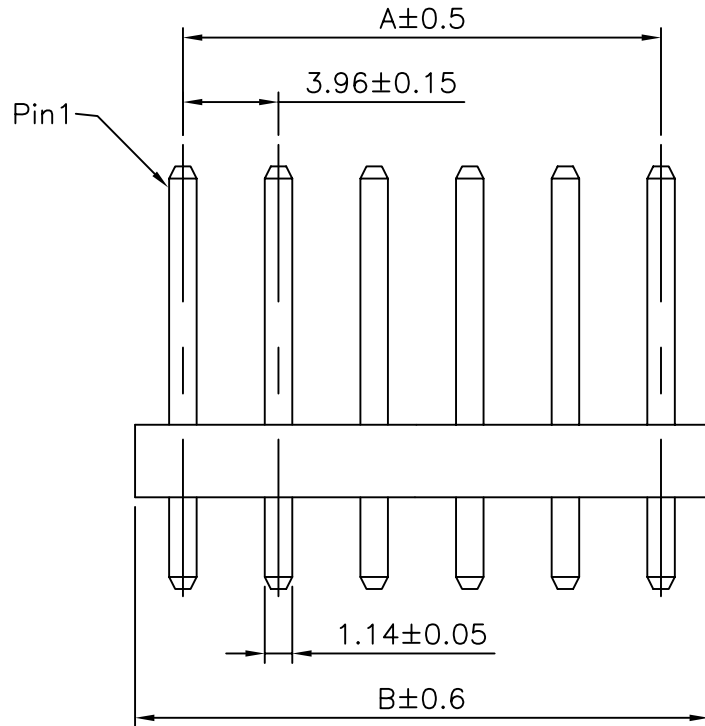

■ SPECIFICATIONS

- Voltage Rating : 250 V AC/DC
- Current Rating : 7A AC/DC
- Withstanding Voltage : 1,500V AC/minute
- Insulation Resistance : 1,000M Ω min
- Temperature Range : - 25°C to + 85°C
- Contact Resistance : 20m Ω max

■ WAFER

- Part No. : 2WB4003-XXX (Straight)
- Poles : 2 - 14
- Material : Contact : Brass, Tin Plated  
Base : Nylon 66 UL94V-2
- Q' ty : 1,000 pcs./Bag

Poles	Dimensions(mm)	
	A	B
2	3.96	7.92
3	7.92	11.88
4	11.88	15.84
5	15.84	19.80
6	19.80	23.76
7	23.76	27.72
8	27.72	31.68
9	31.68	35.64
10	35.64	39.60
11	39.60	43.56
12	43.56	47.52
13	47.52	51.48
14	51.48	55.44

TOLERANCE	LTR	REVISION RECORD	NAME	DATE	LTR	REVISION RECORD	NAME	DATE
.0	±0.30	▲	RoHS Compliant	余秀麗	2005/05/15	▲		
.00	±0.20	▲	套用新圖框, 修改電壓電流, 刪GP	張逸維	2013/02/05	▲		
.000	±0.10	▲				▲		
ANGLE		▲						
0°	±1°	▲						
.0°	±	▲						
SHEET	1/1	▲						

Singatron Enterprise Co., Ltd.

TITLE	3.96mm Crimp Style Connectors Wafer			
DWN	張逸維	PART NO. 2WB4003-XXX		
CHKD	黃科源	SCALE 1:1	UNIT: mm	☉ ↻
APVD	張育瑞	SIZE: A3	SHEET: 1 OF 1	REV: a2
CUSTOMER COPY				

CUSTOMER

Conforms to The RoHS Instruction