

1 2 3 4 5 6 7 8

F

E

D

C

B

A

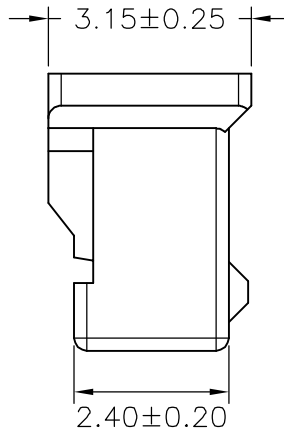
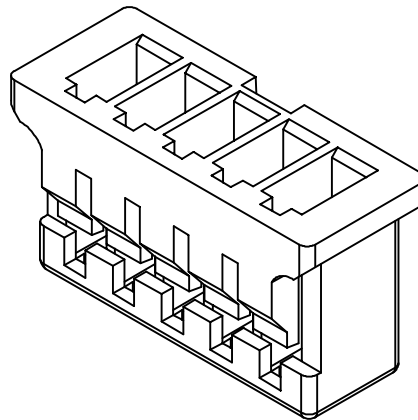
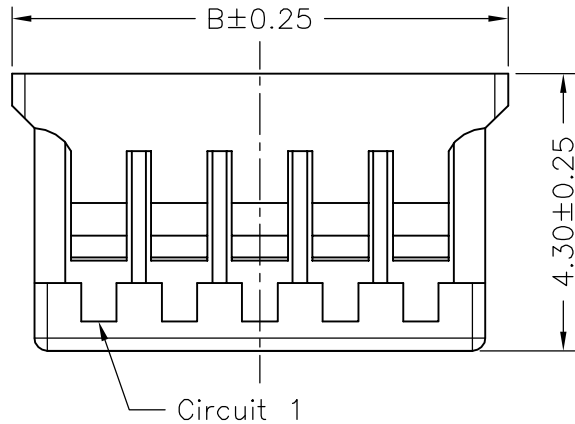
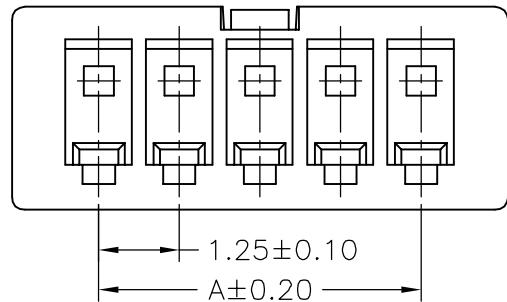

### SPECIFICATIONS

Current Rating: 1A AC,DC  
Voltage Rating: 200V AC,DC  
Temperature Range: -25°C ~ +85°C  
Contact Resistance: 20mΩ Max.  
Insulation Resistance: 100MΩ Min.  
Withstanding Voltage: 500V AC/minute  
Material: Nylon 66,UL94V-0  
Pantone Color: 472C

### Ordering Information & Dimensions

| PART NO.      | Dimensions |       |
|---------------|------------|-------|
|               | A          | B     |
| 2WBA1251H-02P | 1.25       | 3.95  |
| 2WBA1251H-03P | 2.50       | 5.20  |
| 2WBA1251H-04P | 3.75       | 6.45  |
| 2WBA1251H-05P | 5.00       | 7.70  |
| 2WBA1251H-06P | 6.25       | 8.95  |
| 2WBA1251H-07P | 7.50       | 10.20 |
| 2WBA1251H-08P | 8.75       | 11.45 |
| 2WBA1251H-09P | 10.00      | 12.70 |
| 2WBA1251H-10P | 11.25      | 13.95 |
| 2WBA1251H-11P | 12.50      | 15.20 |
| 2WBA1251H-12P | 13.75      | 16.45 |
| 2WBA1251H-13P | 15.00      | 17.70 |
| 2WBA1251H-14P | 16.25      | 18.95 |
| 2WBA1251H-15P | 17.50      | 20.20 |

Singatron Enterprise Co., Ltd.

| TITLE         | 1.25mm PITCH HOUSING |          |               |          |
|---------------|----------------------|----------|---------------|----------|
| DWN           | 董正一                  | PART NO. | 2WBA1251H-XP  |          |
| CHKD          | 2001.02.01           | SCALE    | 1:1           | UNIT: mm |
| APVD          | 董正一                  | SIZE: A3 | SHEET: 1 OF 1 | REV: B1  |
| CUSTOMER COPY |                      |          |               |          |

| REV. | DESCRIPTION | DATE       |
|------|-------------|------------|
| B1   | REVISE      | 2007.12.20 |
| B0   | NEW RELEASE | 2005.11.29 |

| GENERAL TOLERANCE |        |
|-------------------|--------|
| X. X±0.25         | ANGLE± |
| X. XX±0.15        |        |
| X. XXX±0.05       |        |

1 2 3 4 5 6 7 8