

P/N LEGEND

2WBA1254 WR-S-XP XXX
 ① ② ③ ④ ⑤

- ① Series No.
- ② Connector type: WR=Right angle
- ③ Mounting type: S=SMT without post
- ④ No. of circuits
- ⑤ Option code:
 Blank=Contacts/Gold-plated 3u" and Solder tabs/Matte Tin-plated
 D02=Contacts/Gold-plated 3u" and Solder tabs/Gold-flash

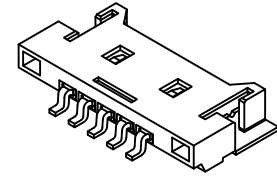

SPECIFICATIONS

Current Rating: 1A AC,DC
 Voltage Rating: 125V AC,DC
 Temperature Range: -25°C ~ +85°C
 Contact Resistance: 20mΩ Max.
 Insulation Resistance: 100MΩ Min.
 Withstanding Voltage: 500V AC/minute
 Pin Material: Brass
 Solder Tabs: Brass
 Material: Nylon 6T,UL94V-0
 Color: Natural(Beige)

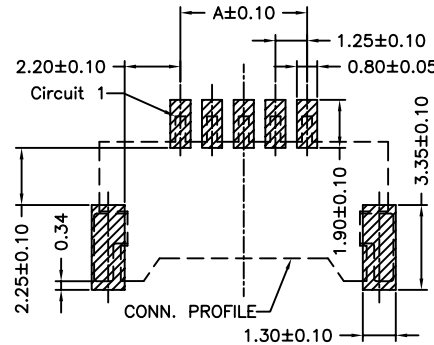
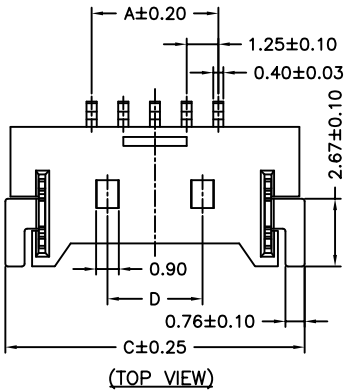

P.C.B LAYOUT (TOP VIEW)

Circuit No.	Dimensions				
	A	B	C	D	E
02P	1.25	7.65	8.07	---	2.90
03P	2.50	8.90	9.32	---	4.15
04P	3.75	10.15	10.57	2.50	5.40
05P	5.00	11.40	11.82	3.75	6.65
06P	6.25	12.65	13.07	5.00	7.90
07P	7.50	13.90	14.32	6.25	9.15
08P	8.75	15.15	15.57	7.50	10.40
09P	10.00	16.40	16.82	8.75	11.65
10P	11.25	17.65	18.07	10.00	12.90
11P	12.50	18.90	19.32	11.25	14.15
12P	13.75	20.15	20.57	12.50	15.40
14P	16.25	22.65	23.07	15.00	17.90
15P	17.50	23.90	24.32	16.25	19.15
16P	18.75	25.15	25.57	17.50	20.40
20P	23.75	30.15	30.57	22.50	25.40
30P	36.25	42.65	43.07	22.50	37.90

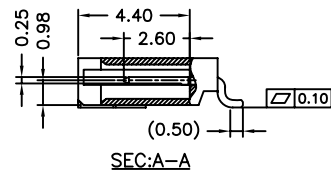
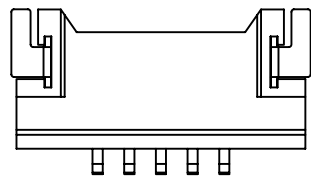
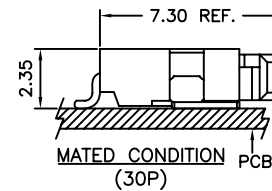
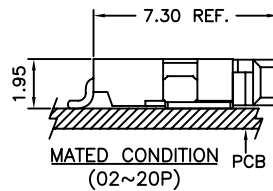
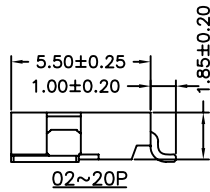
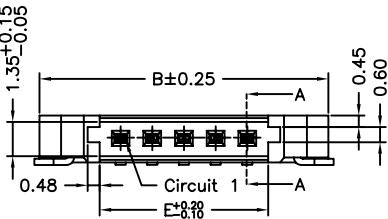

REV.	DESCRIPTION	DATE	NAME	GENERAL TOLERANCE	ANGLE±
C0	EN1306280216	2013.07.01	陳錦展		
B5	EN1306170197	2013.06.17	陳錦展	X.X±0.25	ANGLE±
B4	EN1009270244	2010.09.24	陳錦展	X.XX±0.15	
				X.XXX±0.05	

Singatron Enterprise Co., Ltd.			
TITLE	1.25mm PITCH 90° WAFER-SMT TYPE, ULTRA LOW PROFILE		
DWN	董正一	PART NO.	2WBA1254WR-S-XP
CHKD	2001.02.01	SCALE 1:1	UNIT: mm
APVD	董正一	SIZE: A3	SHEET: 1 OF 1 REV: C0
CUSTOMER COPY			