

1 2 3 4 5 6 7 8

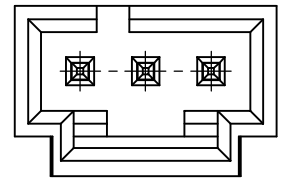

3P

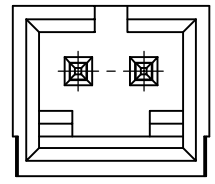

2P

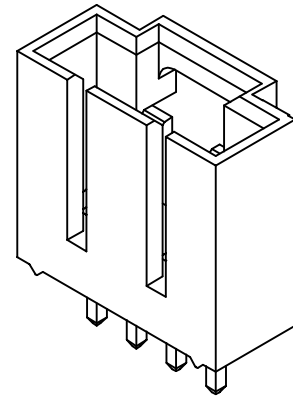

**SPECIFICATIONS**  
 Current Rating: 3A AC,DC  
 Voltage Rating: 250V AC,DC  
 Temperature Range: -25°C ~ +85°C  
 Contact Resistance: 20mΩ Max  
 Insulation Resistance: 1000MΩ Min  
 Withstanding Voltage: 1500V AC/minute  
 Pin Material: Brass/Gold-flash  
 Material: PBT30%GF,UL94V-0  
 Color: Natural(Black)

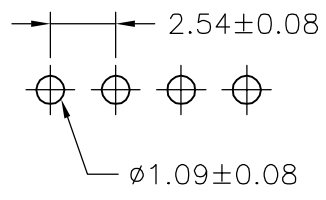
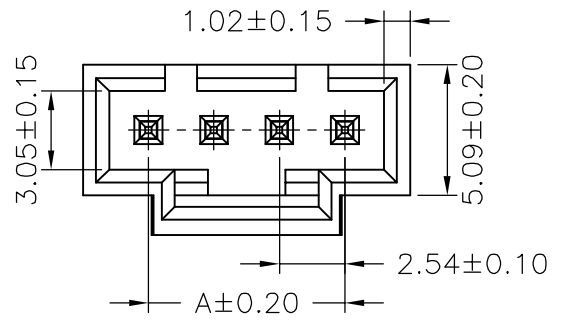

P.C.B LAYOUT

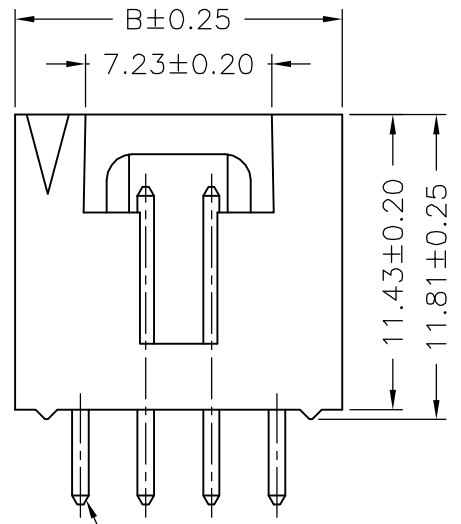

PIN 0.64 SQ,  
Circuit 1

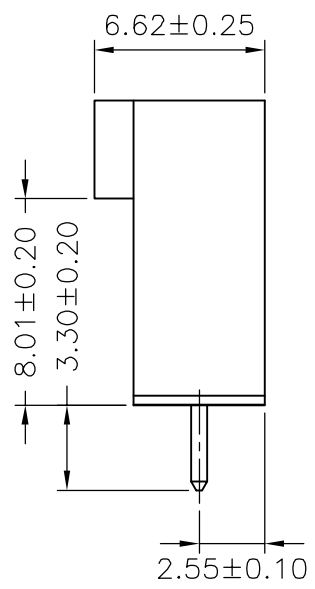

Ordering Information & Dimensions

PART NO.	Dimensions	
	A	B
2WBA2541WV-02P	2.54	7.63
2WBA2541WV-03P	5.08	10.17
2WBA2541WV-04P	7.62	12.71
2WBA2541WV-05P	10.16	15.25
2WBA2541WV-06P	12.70	17.79
2WBA2541WV-07P	15.24	20.33
2WBA2541WV-08P	17.78	22.87
2WBA2541WV-09P	20.32	25.41
2WBA2541WV-10P	22.86	27.95
2WBA2541WV-11P	25.40	30.49
2WBA2541WV-12P	27.94	33.03

Singatron Enterprise Co., Ltd.					
TITLE	2.54mm PITCH 180 WAFER				
DWN	董正一	PART NO.	2WBA2541WV-XP		
CHKD	2001.02.01	SCALE	1:1	UNIT:	mm
APVD	董正一	SIZE:	A3	SHEET:	1 OF 1
		REV:	B0		
<b>CUSTOMER COPY</b>					

			GENERAL TOLERANCE	
			X.X 0.25	ANGLE
B0	NEW RELEASE	2006.04.10	X.XX 0.15	⊕
REV.	DESCRIPTION	DATE	X.XXX 0.05	

1 2 3 4 5 6 7 8