

REV	ECN NO.	DESCRIPTION	DATE	APP'D
A/0	N/A	RELEASE TO PRODUCTION	11/07/11	Paul
A/1	N/A	UPDATE DRAWING	06/05/15	Paul

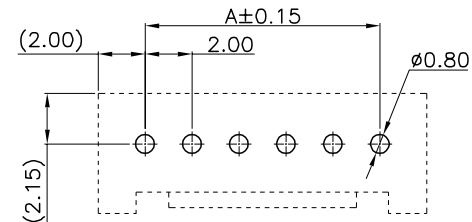

TOLERANCE:  $\pm 0.05$   
RECOMMENDED P.C.B. Layout  
TOP VIEW

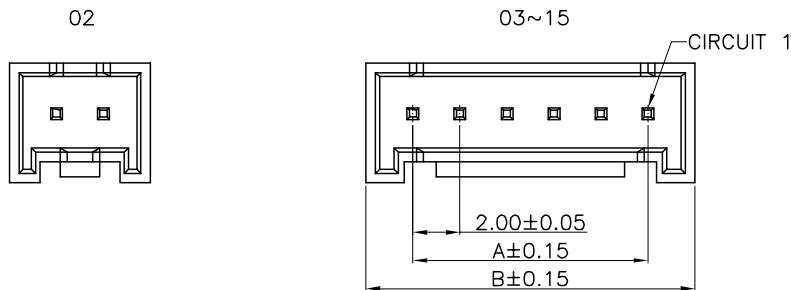
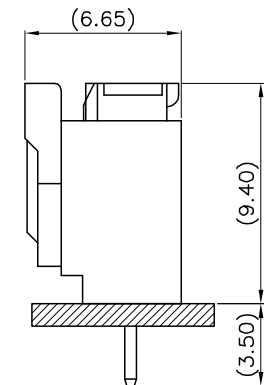
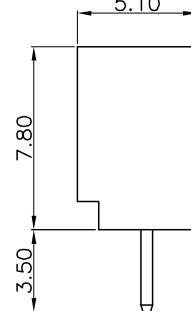
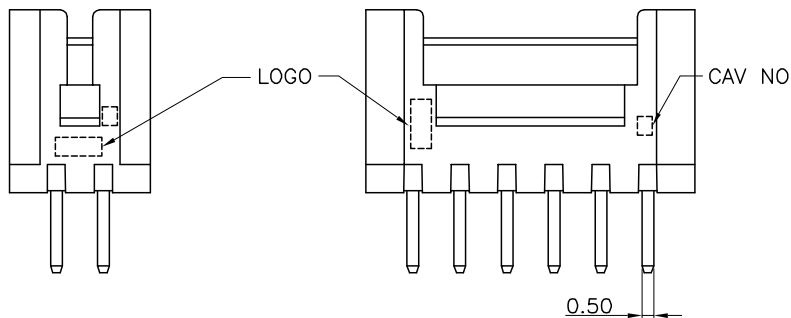

Mating Condition (REF.)

PIN	DIM. (mm)	
	A	B
02	2.00	6.00
03	4.00	8.00
04	6.00	10.00
05	8.00	12.00
06	10.00	14.00
07	12.00	16.00
08	14.00	18.00
09	16.00	20.00
10	18.00	22.00
11	20.00	24.00
12	22.00	26.00
13	24.00	28.00
14	26.00	30.00
15	28.00	32.00
16	30.00	34.00

- NOTES:
- MATERIAL:  
INSULATION(HALOGEN FREE): NYLON 66, UL94V-0 (WHITE)  
CONTACT: BRASS
  - CONTACT FINISH: (VOID)--TIN-PLATED OVER NICKEL  
(C)--MATTE-TIN PLATED OVER NICKEL  
GO--GOLD FLASH OVER NICKEL
  - MATES WITH:2WBTU2008 SERIES HOUSING
  - ORDERING CODE: 2WBTU2008WNV-NP-\*  
NO. OF PINS      FINISH SEE NOTE 2  
02--2 PINS  
03--3 PINS  
§  
16--16 PINS

TOLERANCE		Singatron Enterprise Co., Ltd.			
X.X	$\pm 0.25$	TITLE	WIRE TO BOARD, PITCH 2.00mm, VERTICAL, DIP TYPE, ASSEMBLY		
X.XX	$\pm 0.15$	DWN	Shen Hong 05/05/15	PART NO. 2WBTU2008WNV-NP-*	
ANGULA	3°	CHKD	Paul Shen 06/05/15	SCALE 1:1	UNIT: mm
UNLESS OTHERWISE SPECIFIED		APVD	Wayne Zou 06/05/15	SIZE: A3	SHEET 1 OF 2
<b>CUSTOMER COPY</b>					
				REV: A/1	

REV	ECN NO.	DESCRIPTION	DATE	APP'D
A/0	N/A	RELEASE TO PRODUCTION	11/07/11	Paul
A/1	N/A	UPDATE DRAWING	06/05/15	Paul

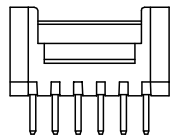

CONNECTOR

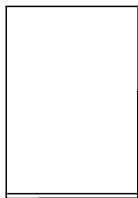

BAG

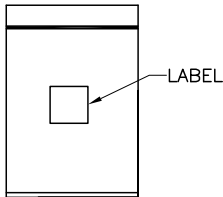

LABEL

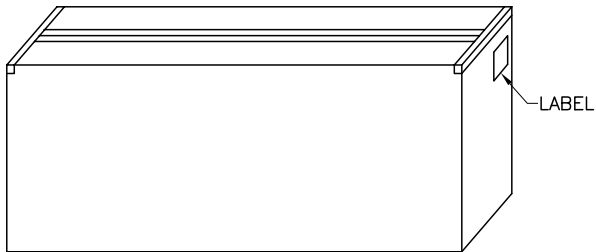

LABEL

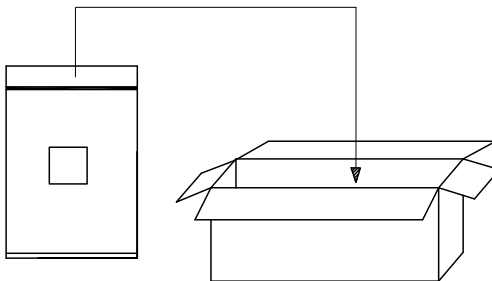

CARTON

NOTES:

- MATERIAL:  
CARTON: FIBREBOARD, CORRUGATED, DOUBLE WALL.  
PE BAG: POLYETHYLENES, TRANSPARENT COLOR.
- DIMENSION:  
PE BAG: SEE TABLE  
CARTON: 400 X 280 X 280 mm.
- QUANTITY: SEE TABLE

PACKING MATERIAL		
PART NAME	PIN	DIM. (mm)
PE BAG	02~03	0.08*150*190
	04~06	0.08*160*240
	07~09	0.08*150*190
	10~16	0.08*160*240

PACKING CAPACITY			
PIN	PCS/BAG	BAG/BC	PCS/BC
02~03	1,000	44	44,000
04~06	1,000	30	30,000
07~16	500	36	18,000

TOLERANCE		Singatron Enterprise Co., Ltd.			
X.X	±0.25				
X.XX	±0.15	TITLE WIRE TO BOARD, PITCH 2.00mm, VERTICAL, DIP TYPE, ASSEMBLY			
ANGULA	3°	DWN	Shen Kong 05/05/15	PART NO. 2WBTU2008WNV-NP-*	
UNLESS OTHERWISE SPECIFIED		CHKD	Paul Chen 06/05/15	SCALE 1:1	UNIT: mm
		APVD	Wayne Zou 06/05/15	SIZE: A3	SHEET 2 OF 2
		REV: A/1			
<b>CUSTOMER COPY</b>					