

A-A SEC

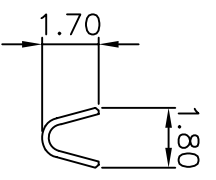

B-B SEC

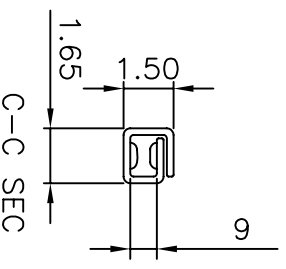

C-C SEC

■ SPECIFICATIONS

- Voltage Rating : 125 V AC/DC
- Current Rating : 3A AC/DC
- Withstanding Voltage : 1000V AC/minute
- Insulation Resistance : 1000MΩ min
- Temperature Range : - 40°C to +105°C
- Contact Resistance : 20mΩ max

■ TERMINAL

- Part No. : 2WT1108-TB; 2WT1108-TB(G): GP Produces
- Applicable Wires : AWG# 22-28
- Material : Brass
- Finish : Tin Plated; Gold Plated
- Thickness : 0.2mm
- Q'ty : 10000 pcs./Reel

TOLERANCE	LTR	REVISION RECORD	DATE	LTR	REVISION RECORD	DATE
0	±0.3	EGR	200511-005	05/11/22		
00	±0.2	EGR	DG 200602-001	06/02/07		
000	±0.1	EGR	DG 200610-008	06/10/27		
ALL	±					
ANGLE	±					
0°	±					
0°	±					

Singatron Enterprise Co., Ltd.			
TITLE	SCALE	SHEET	REV
2.54mm Center Mini Latch Terminal	1:1	1 OF 1	REV: 03
CHKD	SIZE: A3	SHEET: 1 OF 1	REV: 03
APVD	CUSTOMER COPY		

Conforms to The RoHS Instruction