

| REV | ECN.NO. | REVISIONS | REV.DRAWN | DATE |
|-----|---------|-----------|-----------|----------|
| E | | 整理发行 | SUN | 05-06/20 |
| F | | 修正图面与实物相符 | CARRY | 09-02/05 |

SPECIFICATIONS

- . Voltage Rating : 150V AC/DC
- . Current Rating : 1A AC/DC
- . Withstanding Voltage : 500V AC/minute
- . Insulation Resistance : 500MΩ min
- . Temperature Range : -25°C to +85°C
- . Contact Resistance : 20mΩ max

TERMINAL

- . Part No : 2WT1255-T
- . Applicable Wires : AWG#28-32
- . Material : Phos. Bronze
- . Finish : Tin Plated
- . Thickness : 0.15mm
- . Q'ty : 15,000pcs/Reel

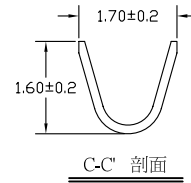
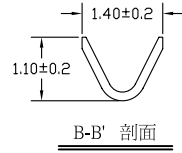
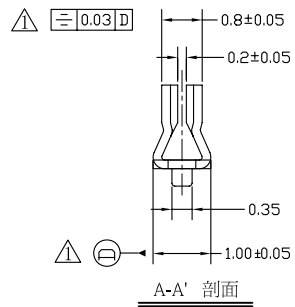
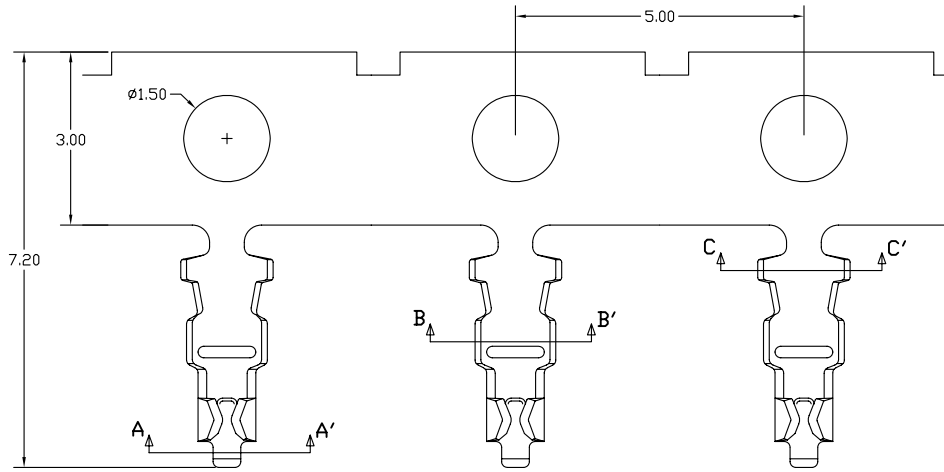
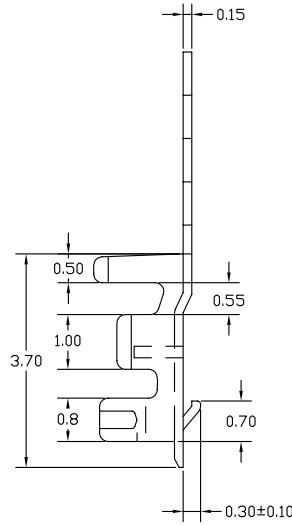

Singatron Enterprise Co., Ltd.

| | | | | | |
|----------------------|--------------|-------|-------------------------|-----------|---------------|
| X.± 0.30 | X°.± 5.0° | TITLE | WIRE TO BOARD CONNECTOR | | |
| .X± 0.15 | .X°.± 2.0° | DWN | PART NO. 2WT1255-T | | |
| .XX± 0.07 | .XX°.± 1.0° | CHKD | xuwei | SCALE 1:1 | UNIT: mm |
| .XXX± 0.03 | .XXX°.± 0.5° | APVD | CARRY | SIZE: A3 | SHEET: 1 OF 1 |
| CUSTOMER COPY | | | | | |
| | | REV | F | | |