

1

2

3

4

5

6

7

8

F

E

D

C

B

A

F

E

D

C

B

A

REV	ECN.NO.	REVISIONS	DRAWN	DATE
A		初版发行	SUN	2009/01/04
B		增加先冲后电镀规格	Asimo	2011/07/12

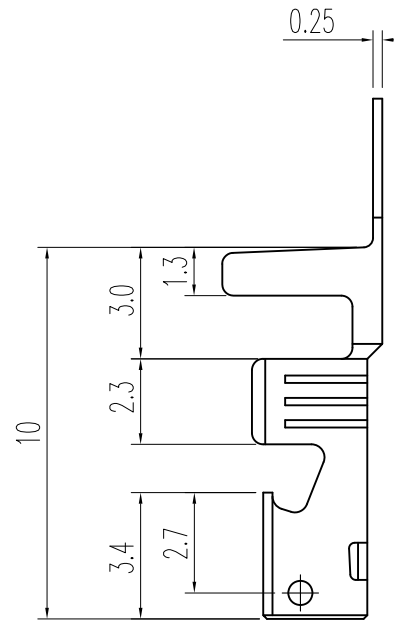
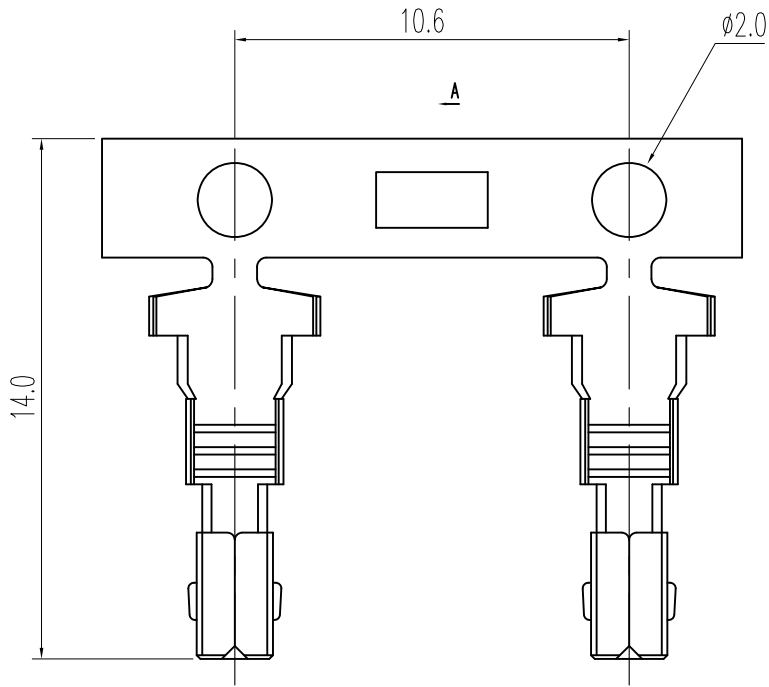

NOTES:

1. MATERIAL: COPPER ALLOY
2. FINISH: SEE PART No.
3. APPLICABLE WIRES: AWG#20~16
4. PART No.

2WT2420-THX

BLANK:PRE-TIN PLATED

Sn>50μ" Ni>10μ"

P:STAMPING BEFORE PLATING

Sn>100μ" Ni>30μ"

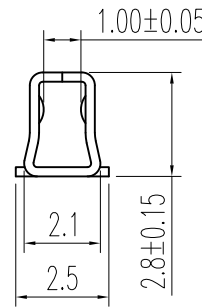
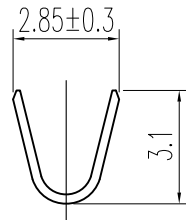
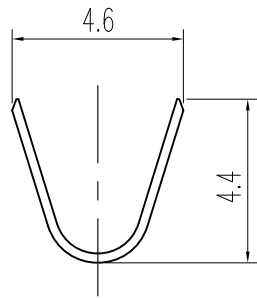

X.±	0.40	X°.±	5.00°	Singatron Enterprise Co., Ltd.			
.X±	0.30	.X°.±	2.00°	TITLE	TERMINAL-SOCKET		
.XX±	0.20	.XX°.±	1.00°	DWN	SUN	PART NO.	2WT2420-TH
.XXX±	0.10	.XXX°.±	--	CHKD		SCALE	1:1 UNIT: mm
<small>THESE DRAWINGS AND SPECIFICATIONS ARE THE PROPERTY OF CHYAO SHIUNN ELECTRONIC CO., LTD. AND SHALL NOT BE REPRODUCED COPIED OR USED IN ANY MANNER WITHOUT THE PRIOR WRITTEN CONSENT OF CHYAO SHIUNN ELECTRONIC CO., LTD.</small>				APVD	liuzhiwen	SIZE: A3	SHEET: 1 OF 1
				CUSTOMER COPY			
				REV:			

1

2

3

4

5

6

7

8