

1 2 3 4 5 6 7 8

F

E

D

C

B

A

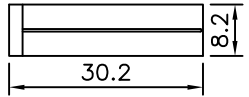

2WW2330A-01

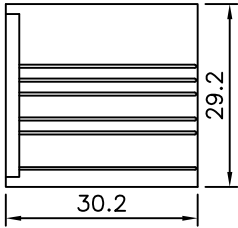

2WW2330A-04

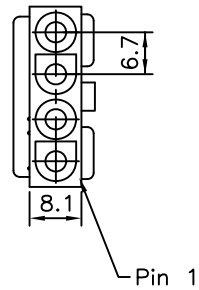

■ SPECIFICATIONS

- Voltage Rating : 600V AC/DC
- Current Rating : 17A AC/DC
- Withstanding Voltage : 5,000V AC/minute
- Insulation Resistance : 1,000MΩ min
- Temperature Range : - 55°C to + 105°C
- Contact Resistance : 20mΩ max

■ HOUSING

- Part No. : 2WW2330A-XXX
- 2WW2330A-XX : GP Produces
- 2WW2330A-0XX: Non GP Produces
- Poles : 1, 2, 3, 4, 6, 9, 12, 15
- Material : Nylon 66 UL94V-2
- Q' ty : 1,000 pcs./Bag

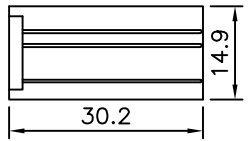

2WW2330A-02

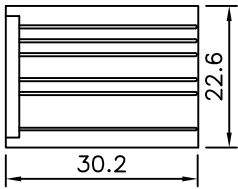
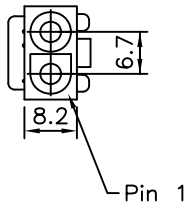

2WW2330A-06

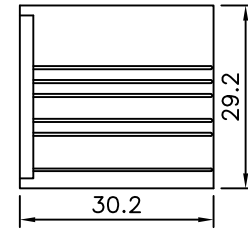
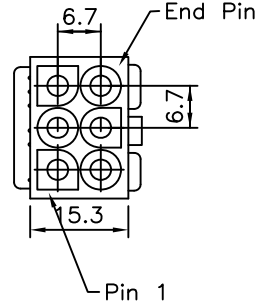

2WW2330A-12

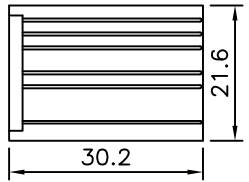
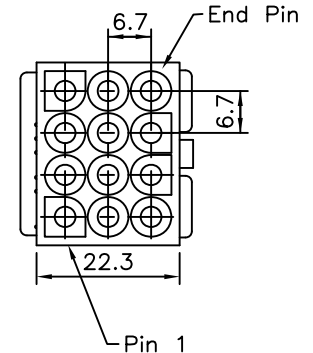

2WW2330A-03

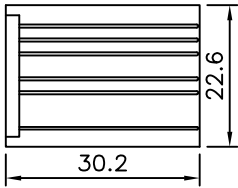
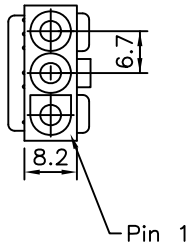

2WW2330A-09

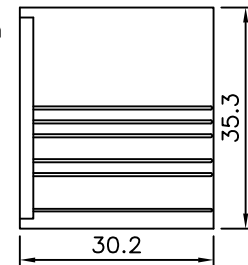
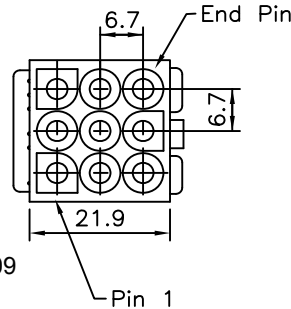

2WW2330A-15

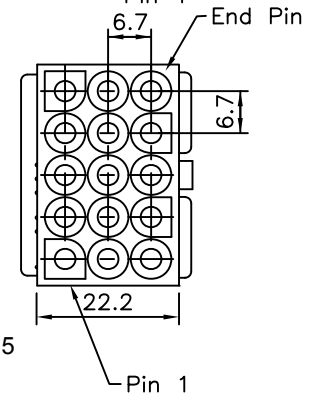

TOLERANCE		LTR	REVISION RECORD	DATE
.0	±0.3	ECR	200510-003	2005/10/13
.00	±0.2			
.000	±0.1			
ALL	±			
ANGLE				
0°	±			
.0°	±			

Singatron Enterprise Co., Ltd.

TITLE	φ2.36mm Power Connectors Terminal			
DWN	陳文松	PART NO.	2WW2330A-XX	
CHKD		SCALE	1:1	UNIT: mm
APVD	林陳樂	SIZE	A3	SHEET: 1 OF 1 REV: a2

CUSTOMER COPY

1 2 3 4 5 6 7 8