

Single Row

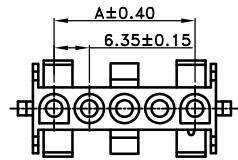

Single Row

Poles	Dimensions(mm)	
	A	B
02	6.35	13.97
03	12.70	20.32
04	19.05	26.67
05	25.40	33.02

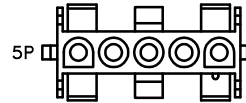
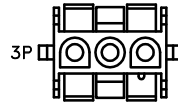
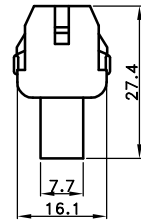
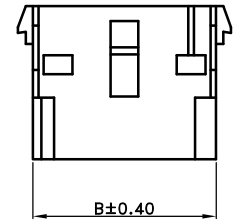
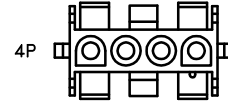
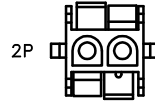

■ SPECIFICATIONS

- Current Rating :
 - 2~5 Circuit : 12A Max.
(With UL1015 AWG #12)
 - 2x3~5x3 Circuit : 9A Max.
(With UL1007 AWG #16)
- Withstanding Voltage : 2,900V AC/minute
- Insulation Resistance : 1,000MΩ min
- Temperature Range : -25 °C to + 85°C
- Contact Resistance : 20mΩ max

■ RECEPTACLE

- Part No. : 2WW6350HX-XX(XX) ⚠
- Product Code
 - Ⓞ Mated Terminal Type
 - F : Mated with Female Type
 - M : Mated with Male Type
 - Ⓟ Poles
 - Single-Row : 02~05
 - Triple-Row : 02x3, 03x3, 04x3, 05x3
 - Ⓠ Material
 - Blank : Nylon66 UL94V-2
 - V0 : Nylon66 UL94V-0
- Material : Refer the above options
- Mate Part :
 - 2WW6350WM Series (with 2WT6350HF) ⚠
 - 2WW6350WF Series (with 2WT6350HM) ⚠
- Packing : Bag

Triple Row

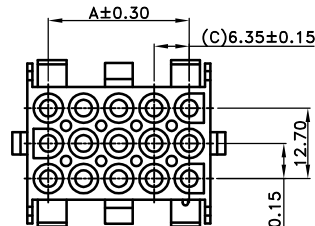

Triple Row

Poles	Dimensions(mm)	
	A	B
2*3	6.35	13.97
3*3	12.70	20.32
4*3	19.05	26.67
5*3	25.40	33.60

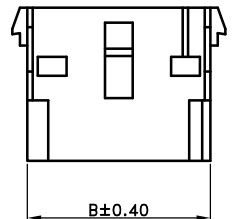
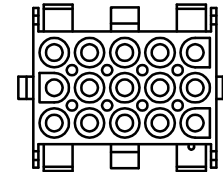
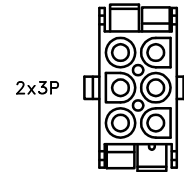

(D)6.35±0.15

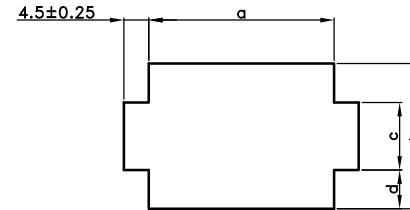
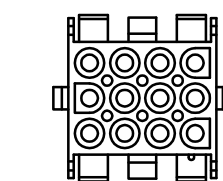
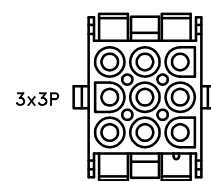
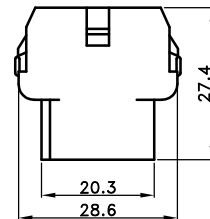

Single Row

Poles	Dimensions(mm)			
	a	b	c	d
2	14.35			
3	20.70	13.50	8.64	2.41
4	27.05			
5	33.40			

Triple Row

Poles	Dimensions(mm)			
	a	b	c	d
2x3	14.35			
3x3	20.70	26.16	12.20	6.98
4x3	27.05			
5x3	33.40			

Recommended Panel Cutout

<p>⚠</p> <p>Male Terminal (Split Type): Product No. : 2WT6350H-TX1</p> <p>* Only available to use in Triple-Row</p>	<p>Male Terminal (Solid Type): Product No. : 2WT6350H-TX</p> <p>* Only available to use in Single-Row</p>	<p>Female Terminal: Product No. : 2WT6350W-TX</p>
Mated with 6350WF		Mated with 6350WM

TOLERANCE	LTR	REVISION RECORD	NAME	DATE	LTR	REVISION RECORD	NAME	DATE
.0	±0.40	△ 合併並修改料號	王誠賢	2011/11/01	△			
.00	±0.20	△ 產品應用敘述修改	王誠賢	2012/01/30	△			
.000	±0.10	△			△			
ANGLE								
0°	±1°	△						
.0°	±	△						
SHEET	1/1	△						

Singatron Enterprise Co., Ltd.

TITLE	6.35mm Wire to Wire Power Conn, Receptacle Type			
DWN	王誠賢	PART NO. 2WW6350HX-XX(XX)		
CHKD	黃科源	SCALE 1:1	UNIT: mm	Ⓞ
APVD	張育瑞	SIZE: A3	SHEET: 1 OF 1	REV: a2

CUSTOMER COPY

Conforms to The RoHS Instruction