

1 2 3 4 5 6 7 8

REV.	ECN NO.	DESCRIPTION	DRAWN	APPD.

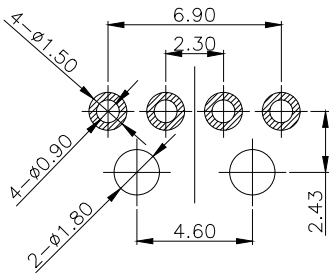
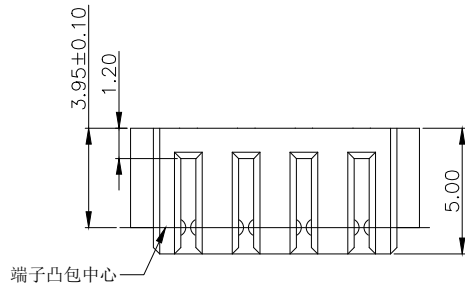

RECOMMENDED P.C BOARD LAYOUT (TOP VIEW)  
TOLERANCES UNLESS OTHERWISE SPECIFIED ±0.05  
PAD AREA

**SPECIFICATION**

- Mechanical performance:
  - 1.1 Insertion and extraction force: 0.1~2.0kgf,
  - 1.2 Durability: 3000 cycles .
- Electrical and environment performance
  - 2.1 Current rating: 1A
  - 2.2 Voltage rating: 8V
  - 2.3 Insulation resistance: 100MΩ Min. at 500V DC (After Testing)
  - 2.4 Terminal contact resistance: 30mΩ Max.
  - 2.5 Withstanding voltage: 500V(r.m.s.)AC at 1mA Max. for one minute
  - 2.6 Operating temperature: -20°C~ +80°C
- Packing Regulation: Tray

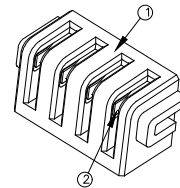
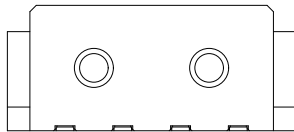
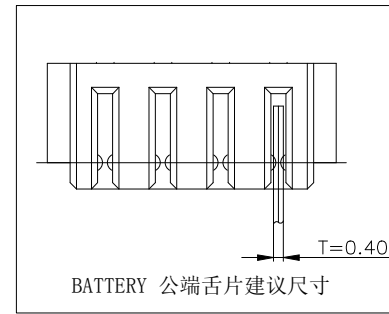
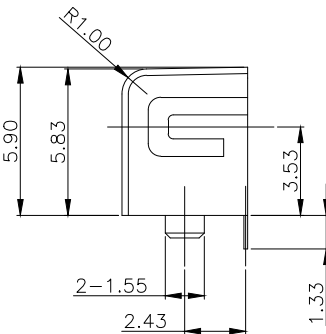
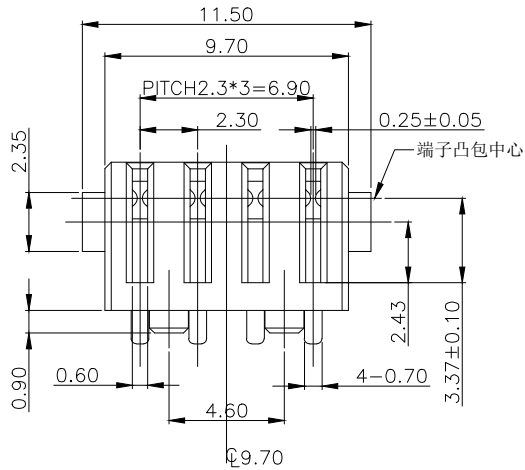

②	TERMINAL	COPPER ALLOY	SEE PART NO.
①	HOUSING	HIGH TEMP. PLASTIC	BLACK UL94V-0
NO.	DESCRIPTION	MATERIAL	COLOR R/FMARK

**Singatron Enterprise Co., Ltd.**

GENERAL TOLERANCE		TITLE	BATTERY Pitch 2.30 4P R/A Thru-hole Type with post H:2.90		
XX. ±	XXX. ±	DWN	AMT 2017/09/25	<b>PART NO. 2BA22234-C590300</b>	
X. ± 0.30	.XXX ± 0.05	CHKD	ALICE	SCALE 1:1	UNIT: mm
.X ± 0.25	X.° ± 3°	APVD	JAMES	SIZE: A3	SHEET: 1 OF 1
.XX ± 0.20	.X.° ± 2°	<b>REV: 1</b>			

**CUSTOMER COPY**

1 2 3 4 5 6 7 8