

REV.	ECN NO OR DESCRIPTION	REVISED	DATE
A	INITIAL RELEASE	CHRIS	01/03/11

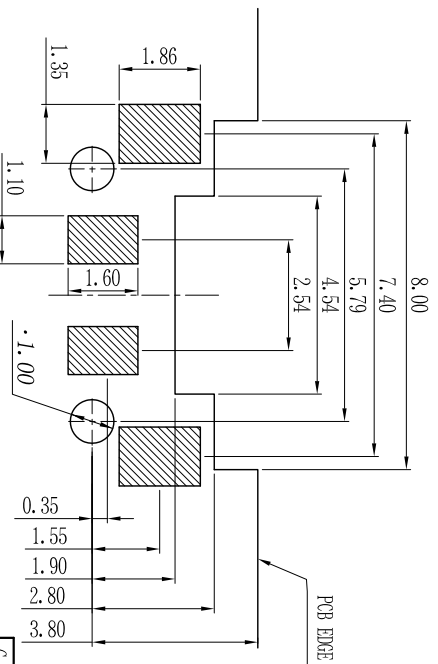
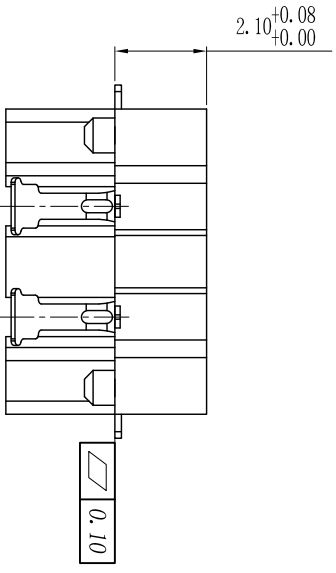
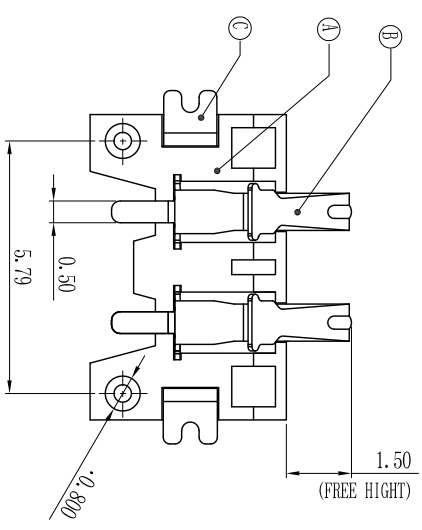
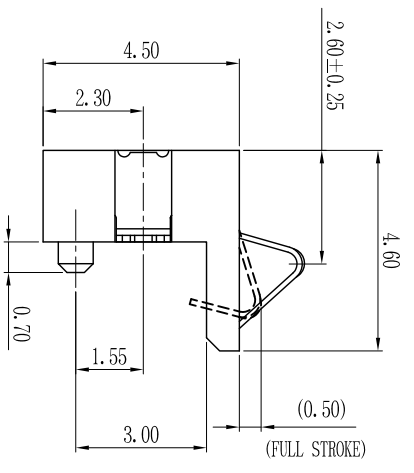
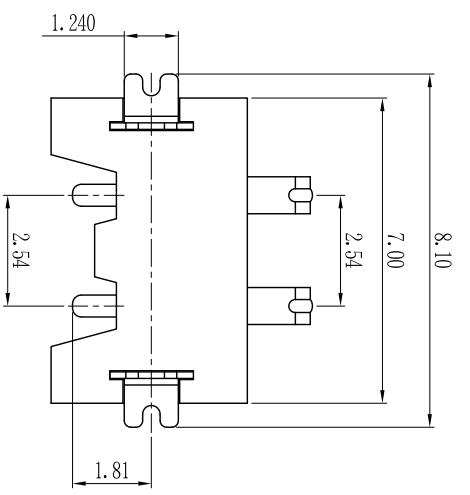

RECOMMENDED PCB LAYOUT
TOLERANCE: ±0.05mm

SPECIFICATIONS:

- ELECTRICAL CHARACTERISTICS:
 - CURRENT RATING : 2A MAX.
 - VOLTAGE RATING: 12V DC
 - CONTACT RESISTANCE: 30mΩ MAX.
 - INSULATION RESISTANCE: 100MΩ MIN. AT 25°C DC.
 - DIELECTRIC WITHSTANDING VOLTAGE : 500V AC R.M.S FOR ONE MINUTE.
- MECHANICAL CHARACTERISTICS:
 - CONTACT NORMAL FORCE: 80gf/MIN.
 - DURABILITY: 8000 CYCLES.
 - OPERATING TEMPERATURE : -40° C TO +85 ° C.
 - OTHER GENERAL SPEC. TO REFER "20C1015 SPRINGS SPEC".
 - FOR BEFLOW SOLDERING LEAD-FREE PROCESS.
 - GREEN PRODUCT IDENTIFICATION LABEL ON PACKAGING.

C	GROUNDING	2	COPPER ALLOY 0.15T	TIN PLATED
B	CONTACT	2	COPPER ALLOY 0.12T	G/P PLATED
A	HOUSING	1	HIGH TEMP PLASTIC	BLACK
NO	DESCRIPTION	QTY	MATERIAL	PLATING & COLOR

UNLESS OTHERWISE SPECIFIED TOLERANCES

Singatron Enterprise Co., Ltd.

TITLE: 2.54 PITCH BATTERY 2PIN

DECIMALS: ANGLES:

X : ±0.5 X : ±2°

K.X : ±0.3 K.X : ±1°

K.XX : ±0.2

DWG	CHRIS 01/03/11	PART NO.	28A2Y01-000111
CHKD	TONY 01/03/11	SCALE	1:1
APVD	SEAN 01/03/11	SIZE	A4
		SHEET	10/11
		REV.	A

CUSTOMER COPY