

1 2 3 4 5 6 7 8

REV.	ECN NO OR DESCRIPTION	REVISED	DATE
A	PDR NO.S170209-3B	MARS	2020.01.07
B	ECN NO.S202004-R07 ECN NO.S202005-E15	MARS	2020.07.17

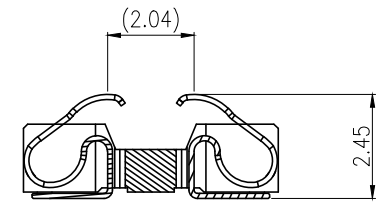

下壓最小行程

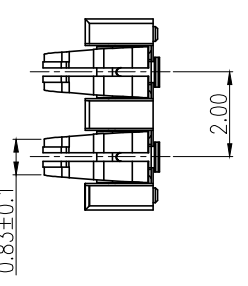
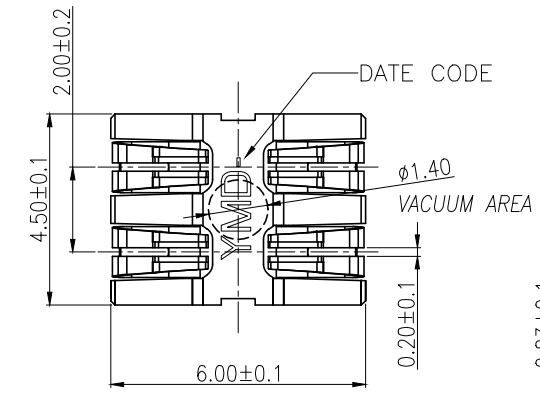
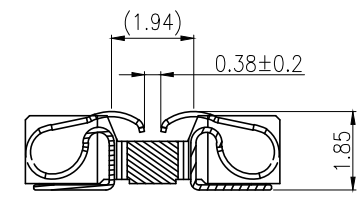

下壓最大行程

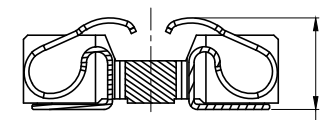

SECTION A-A

Ref. Note2-2

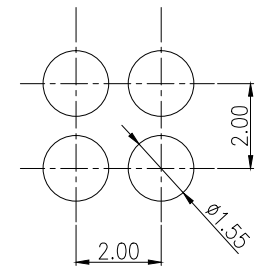

REFERENCE CONTACT SURFACE

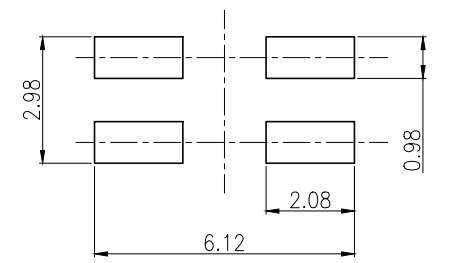

RECOMMENDED PCB LAYOUT(TOP VIEW)  
(TOLERANCE:±0.05)

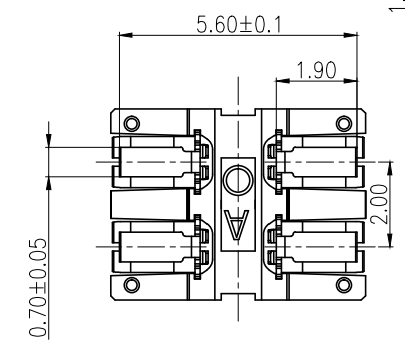
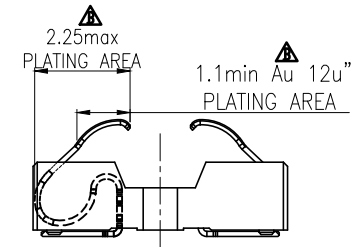
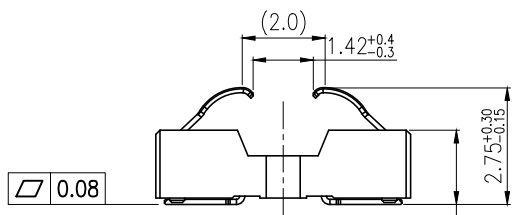

SPECIFICATIONS:

1. ELECTRICAL CHARACTERISTICS:
  - 1-1. CURRENT RATING: 0.5A MAX.
  - 1-2. VOLTAGE RATING: 20V MAX.
  - 1-3. CONTACT RESISTANCE: 50mΩ MAX.(INITIAL).  
100mΩ MAX.(AFTER LIFE TEST).
  - 1-4. INSULATION RESISTANCE: 100MΩ MIN.
2. MECHANICAL CHARACTERISTICS:
  - 2-1. DURABILITY: 1000 CYCLES.
  - 2-2. CONTACT FORCE: 0.40N MIN. AT THIS DIMENSION.
  - 2-3. OPERATING TEMPERATURE: -40°C ~ +85°C.
3. PACKAGING : TAPE & REEL.
4. TO CONFORM TO SINGATRON HAZARDOUS SUBSTANCE FREE SPEC.
5. FOR REFLOW SOLDERING LEAD-FREE PROCESS.

B	HOUSING	1	LCP	BLACK
A	CONTACT	4	COPPER ALLOY T:0.12mm	Au 12u" MIN ON CONTACT AREA, Au 1.2u" MIN SOLDER AREA, All OVER NI 50u"~120u".
NO	DESCRIPTION	QTY	MATERIAL	PLATING & COLOR
UNLESS OTHERWISE SPECIFIED TOLERANCES		Singatron Enterprise Co., Ltd. 信音企業股份有限公司		
DECIMALS: ANGLES:		TITLE: BATTERY CONNETOR		
X	:±0.5	X	:±2°	DWN Mars PART NO.2BA3070-004111F
X.X	:±0.3	X.X	:±1°	CHKD CERRY SCALE 8:1 UNIT: mm
X.XX	:±0.2	APVD WILLIAM	SIZE: A3	SHEET:1 OF 1 REV: B
CUSTOMER COPY				

1 2 3 4 5 6 7 8