

REV.	ECN NO OR DESCRIPTION	REVISED	DATE
A	PDR NO.S160922-2A	Jttlucky	2017.04.14

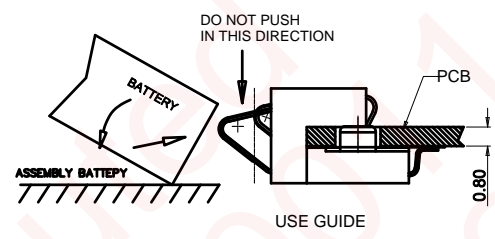

- NOTES:
- ELECTRICAL PERFORMANCES:
 - 1-1. RATING CURRENT:2A
 - 1-2. RATING VOLTAGE:100VAC
 - 1-3. CONTACT RESISTANCE: 50 Ω_m
 - 1-4. INSULATION RESISTANCE:1000 Ω_M
 - 1-5. DIELECTRIC WITHSTANDING VOLTAGE: 500VAC FOR 1 MINUTE
 - MECHANICAL PERFORMANCE:
 - 2-1. DURABILITY:5000TIMES
 - 2-2. NORMAL FORCE AT WORKING POSITION:80gf Min.
 - 2-3. OPERATION TEMPERATURE:-40° C ~ +85° C.

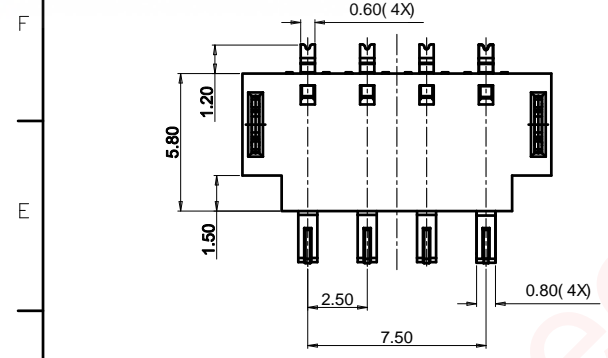
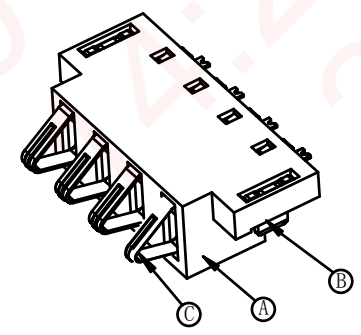
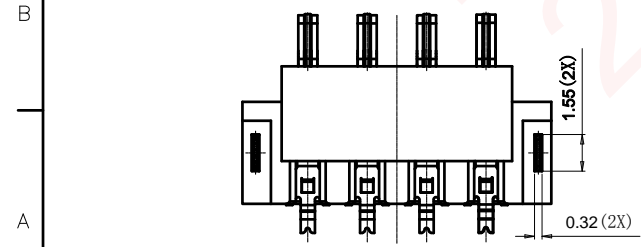
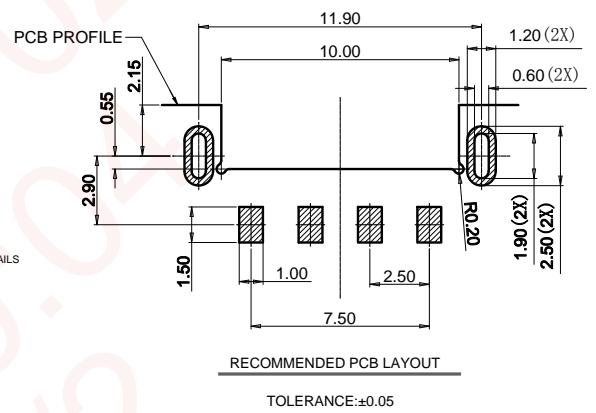
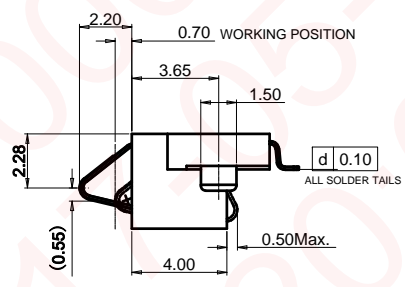
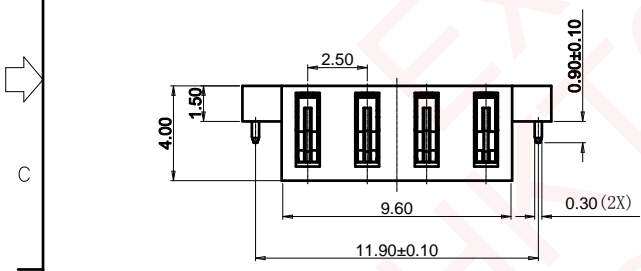

C	PAD 1	2	STAINLESS STEEL	Ni PLATING OVER ALL TIN PLATING OVER ALL
B	CONTACT	4	COPPER ALLOY	Au PLATING OVER Ni AT CONTACT AREA Tin PLATING OVER Ni AT SOLDER AREA
A	HOUSING	1	THERMOPLASTIC UL94V-0	BLACK
NO	DESCRIPTION	QTY	MATERIAL	PLATING & COLOR
UNLESS OTHERWISE SPECIFIED TOLERANCES			Singatron Enterprise Co., Ltd. 信音企業股份有限公司	
DECIMALS:		TITLE		
X :±0.5		2.2PITCH 4PIN 4.0H BATTERY CONN. (IN BOARD TYPE)		
X.X :±0.3		DWN Jttlucky PART NO.2BA3Y28-204412F		
X.XX :±0.2		CHKD James SCALE N/A UNIT: mm		
		APVD Boye SIZE: A3 SHEET: 10F1 REV: A		
CUSTOMER COPY				