

REV.	ECN NO OR DESCRIPTION	REVISED	DATE
A	PDR NO.S160922-3A	Jttlucky	2017.04.20

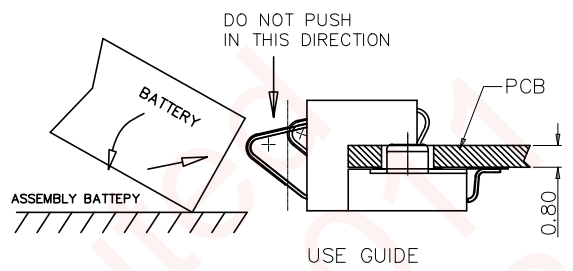

- NOTES:
- ELECTRICAL PERFORMANCES:
 - 1-1. RATING CURRENT: 2A
 - 1-2. RATING VOLTAGE: 100VAC
 - 1-3. CONTACT RESISTANCE: 50 $\mu\Omega$
 - 1-4. INSULATION RESISTANCE: 1000 ΩM
 - 1-5. DIELECTRIC WITHSTANDING VOLTAGE: 500VAC FOR 1 MINUTE
 - MECHANICAL PERFORMANCE:
 - 2-1. DURABILITY: 5000TIMES
 - 2-2. NORMAL FORCE AT WORKING POSITION: 80gf Min.
 - 2-3. OPERATION TEMPERATURE: -40° C~+85° C.

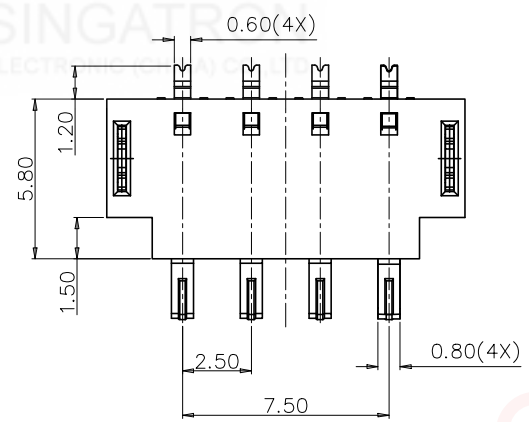
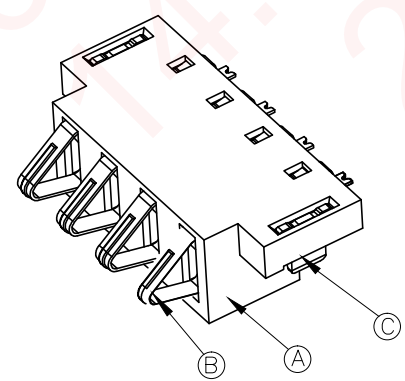
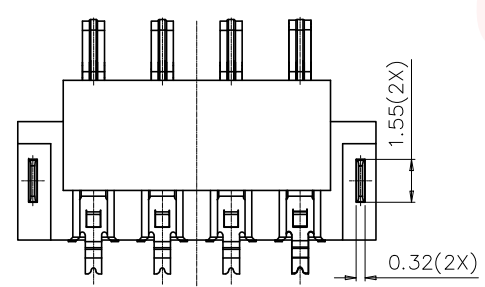
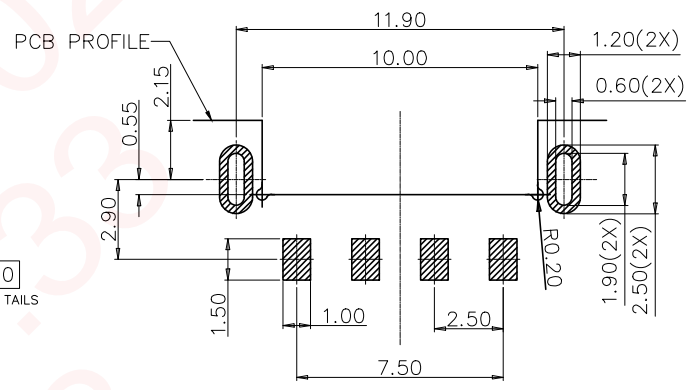
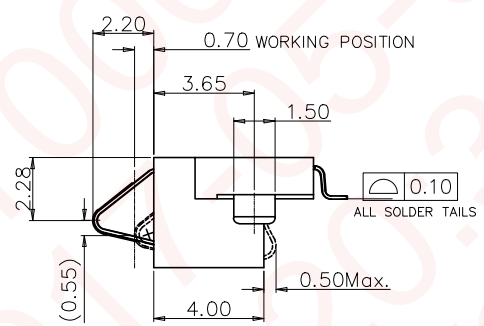
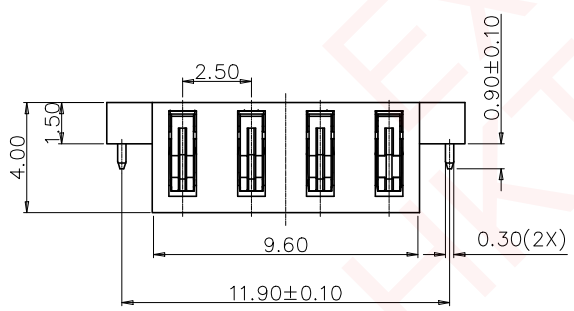

C	PAD 1	2	STAINLESS STEEL	NI PLATING OVER ALL TIN PLATING OVER ALL
B	CONTACT	4	COPPER ALLOY	Au PLATING OVER Ni AT CONTACT AREA Tin PLATING OVER Ni AT SOLDER AREA
A	HOUSING	1	THERMOPLASTIC UL94V-0	BLACK
NO	DESCRIPTION	QTY	MATERIAL	PLATING & COLOR

UNLESS OTHERWISE SPECIFIED TOLERANCES

Singatron Enterprise Co., Ltd.
信音企業股份有限公司

DECIMALS:	ANGLES:	TITLE	2.2PITCH 4PIN 4.0H BATTERY CONN. (IN BOARD TYPE)	
X :±0.5	X :±2°	DWN	Jttlucky	PART NO.2BA3Y28-214412F
X.X :±0.3	X.X :±1°	CHKD	James	SCALE N/A UNIT: mm
X.XX :±0.2		APVD	Boye	SIZE: A3 SHEET: 10F1 REV: A
CUSTOMER COPY				