

# Side Entry Modular Telephone Jack

3050 Series

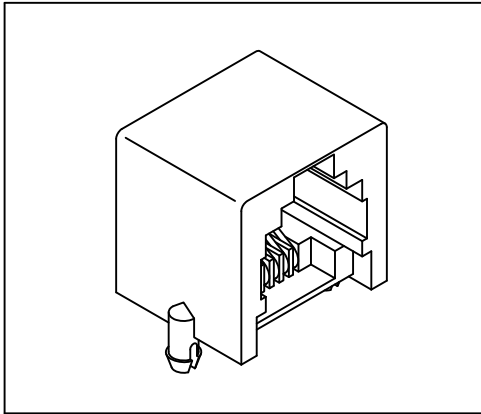

## Material and Finish:

- \* Housing: PBT Polyester UL94V-0 mixed Glass Fiber.  
Standard Color: Black.
- \* Contact: 0.45mm Diameter Phosphor Bronze.  
Gold Plating over Nickel.
- \* Cavity conforms to FCC rules and regulations part 68, subpart F.
- \* RoHS compliant.

## P.C.B. Hole Layout

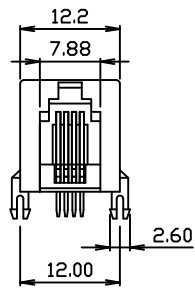

4 Position

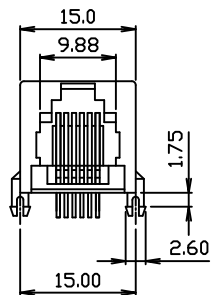
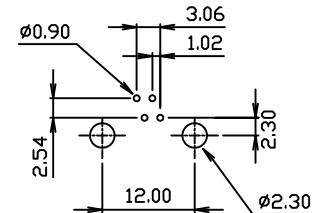
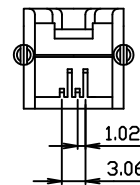
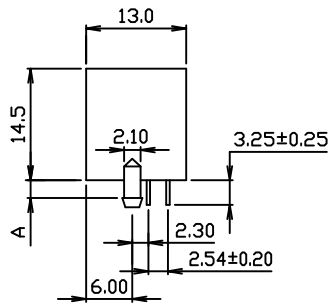

6 Position

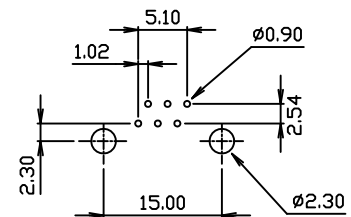
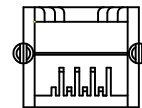
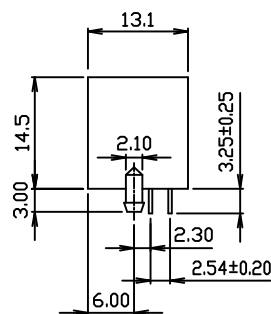

## Ordering Information

Series No.	No. of Position	No. of Contact	Keyed	Contact Plating
3050	6	6	2	1 — B
	4	2	w/o key 2	6 μ" 1
	6	4		15 μ" 2
		6		30 μ" 3
				50 μ" 4